

LEGEND		
EXISTING	PROPOSED	
— W —	— W —	WATER MAIN
— SS —	— SS —	SANITARY SEWER MAIN
— FM —	— FM —	FORCE MAIN
— SD —	— SD —	STORM MAIN
— RD —	— RD —	ROOF DRAIN
	— FD —	FOOTING DRAIN
— G —	— G —	GAS LINE
— UGP —	— UGP —	POWER LINE
— T —	— T —	TELEPHONE LINE
— TV —	— CATV —	CABLE TV LINE
— — — — —	— — — — —	ROADWAY CENTERLINE
— — — — —	— — — — —	RIGHT-OF-WAY LINE
— — — — —	— — — — —	EASEMENT LINE
— — — — —	— — — — —	FRONT/BACK OF CURB
— — — — —	— — — — —	EDGE OF GRAVEL SHOULDER
— EP —	— — — — —	EDGE OF PAVEMENT

GEOTECHNICAL NOTE
 A GEOTECHNICAL REPORT WAS NOT PREPARED FOR THIS PROJECT. IN LIEU OF A REPORT, ALL RETAINING WALL CONSTRUCTION, EARTHWORK, SUB-GRADE PREPARATION, AND PAVING ACTIVITIES SHALL COMPLY WITH THE STANDARD SPECIFICATIONS AND THE IBC.

WORK IN COUNTY RIGHT-OF-WAY
 CONTRACTOR TO OBTAIN RIGHT OF WAY PERMIT PRIOR TO ANY WORK WITHIN COUNTY RIGHT OF WAY. ALL WORK WITHIN COUNTY RIGHT OF WAY SHALL ADHERE TO COUNTY STANDARDS AS OUTLINED IN THE RIGHT OF WAY PERMIT.

TOPOGRAPHIC NOTE
 TOPOGRAPHIC INFORMATION DEPICTED HEREON WAS PROVIDED BY CANDU ENVIRONMENTAL LLC. TOPOGRAPHIC INFORMATION WAS NOT FIELD VERIFIED BY RB ENGINEERING.

HAMPE WAY MULTI-FAMILY DEVELOPMENT

SECTION 20, TOWNSHIP 14 NORTH, RANGE 02 WEST, W.M.
 LEWIS COUNTY, WASHINGTON

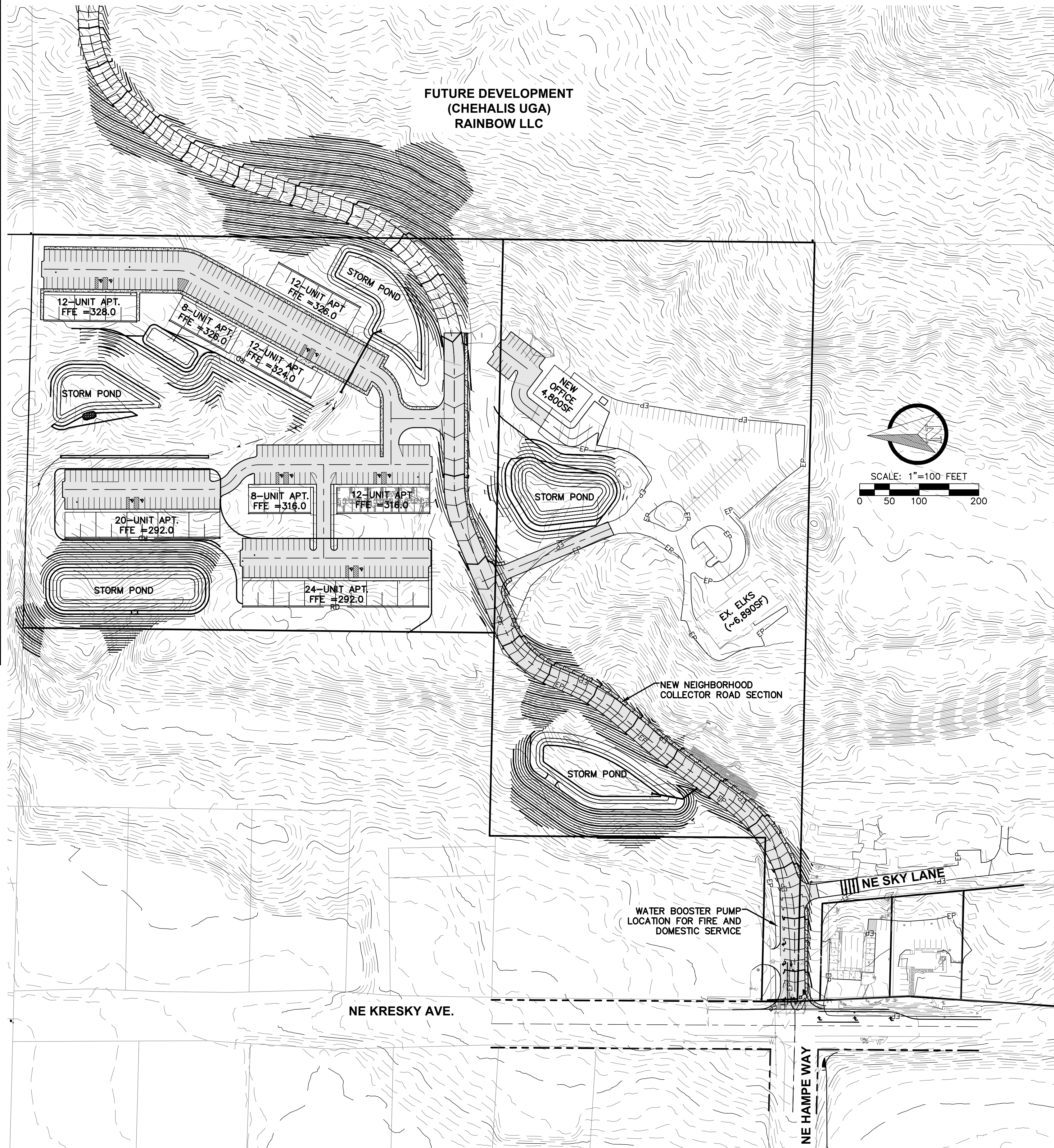

FUTURE DEVELOPMENT
 (CHEHALIS UGA)
 RAINBOW LLC

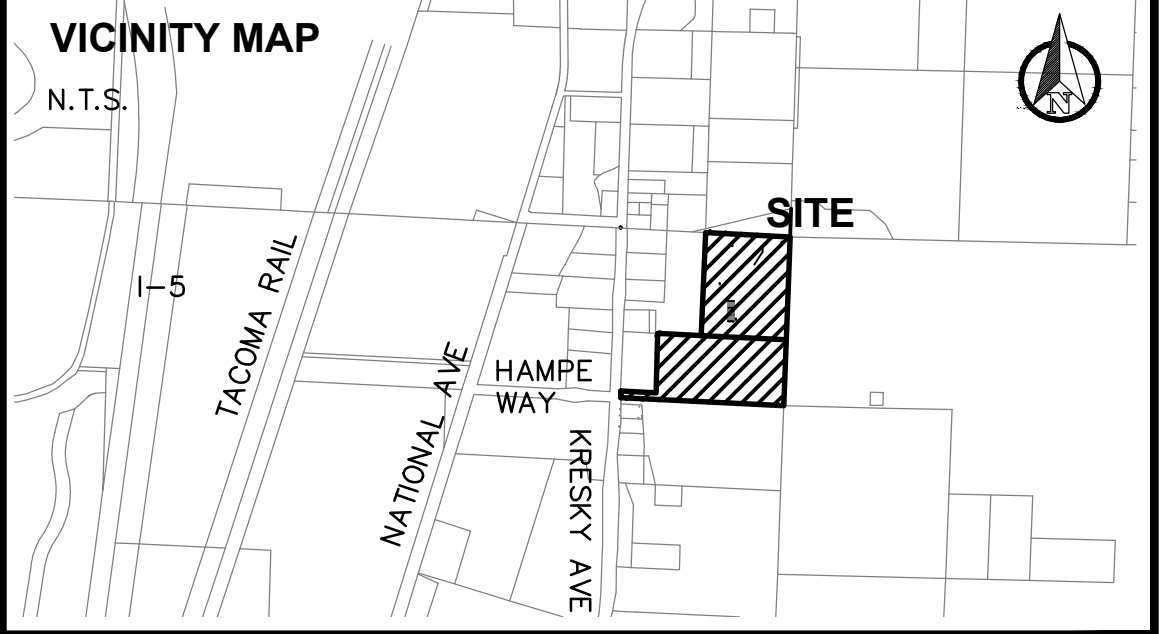
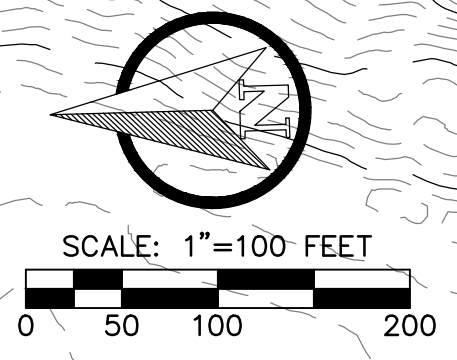

PROJECT INFORMATION	
APPLICANT:	MR. JOHN BRAUN RAINDROP PROPERTIES LLC PO BOX 1224 CHEHALIS, WA 98532 360.748.0195
SURVEYOR:	BUTLER SURVEYING INC. 475 NW CHEHALIS AVE CHEHALIS, WA 98532 PH.: 360.748.8803
PARCEL NOS:	021630003000, 021629002000
SITE ADDRESS:	2501 NE KRESKY AVE STE A CHEHALIS, WA 98532
ZONING:	CG-GENERAL COMMERCIAL / CITY
SITE AREA:	24.37 TOTAL ACRES
BLDG COVERAGE:	~70,660 SF (1.62 AC) = 6.6%
SITE COVERAGE :	~305,410 SF (7.01 AC) = 28.7%
RESIDENTIAL DENSITY:	108 UNITS; 8 NEW, 2-STORY MULTIFAMILY 9 DU/AC
COMMERCIAL (12.37 AC)	1- EXISTING, 1-NEW, 4,800 SF OFFICE
PARKING STALLS:	291 TOTAL STALLS (RESIDENTIAL) 2.7 STALLS/DU
BUILDING SETBACKS:	FRONT - 15' SIDE - 5' REAR - 10'
GRADING:	XX± CY CUT, XX± CY FILL
SOILS:	27- BUCKPEAK SILT LOAM (30-65% SLOPES) 130- MELBOURNE LOAM (0-8% SLOPES) 131- MELBOURNE LOAM (8-15% SLOPES) 132- MELBOURNE LOAM (15-30% SLOPES)
SANITARY SEWER:	PROPOSED CITY OF CHEHALIS
WATER:	PROPOSED CITY OF CHEHALIS
FIRE DISTRICT:	RIVERSIDE FIRE AUTHORITY

SHEET INDEX	
P0.1	OVERALL SITE PLAN AND PROJECT INFORMATION
P1.1	PRELIMINARY MULTI-FAMILY AND ELKS SITE PLAN
P1.2	PRELIMINARY ROAD, UTILITY AND DRAINAGE PLAN
P1.3	PRELIMINARY ROAD, UTILITY AND DRAINAGE PLAN
P1.4	PRELIMINARY ROAD, UTILITY AND DRAINAGE PLAN
P1.5	PRELIMINARY DETAILS AND CROSS SECTIONS

SURVEY INFORMATION	
LEGAL DESCRIPTION	
VERTICAL DATUM	
BASIS OF BEARING	

NO.	DATE	REVISION
DESIGNED BY: <u>RWB</u>	DRAWN BY: <u>ALE</u>	CHECKED BY: <u>RWB</u>
DATE: 01/06/2023		
SCALE: 1" = 100'		
HAMPE WAY MULTI-FAMILY DEVELOPMENT		
OVERALL SITE PLAN AND PROJECT INFORMATION		
		WA.
RB Engineering DESIGN → PERMIT → MANAGE OFF: (360) 740-8819 EMAIL: info@rbengineers.com P.O. Box 923 CHEHALIS, WA 98532		
811 Know what's below. Call 811 before you dig.		
JOB NUMBER 19081 DRAWING NAME 19081_P0.1_OVSTPL P0.1 1 OF 6		