

SECURE TOY STORAGE

SECTION 09, TOWNSHIP 13 NORTH, RANGE 02 WEST, W.M.
LEWIS COUNTY, WASHINGTON

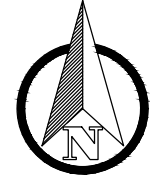

SCALE: 1"=40 FEET
0 20 40 80

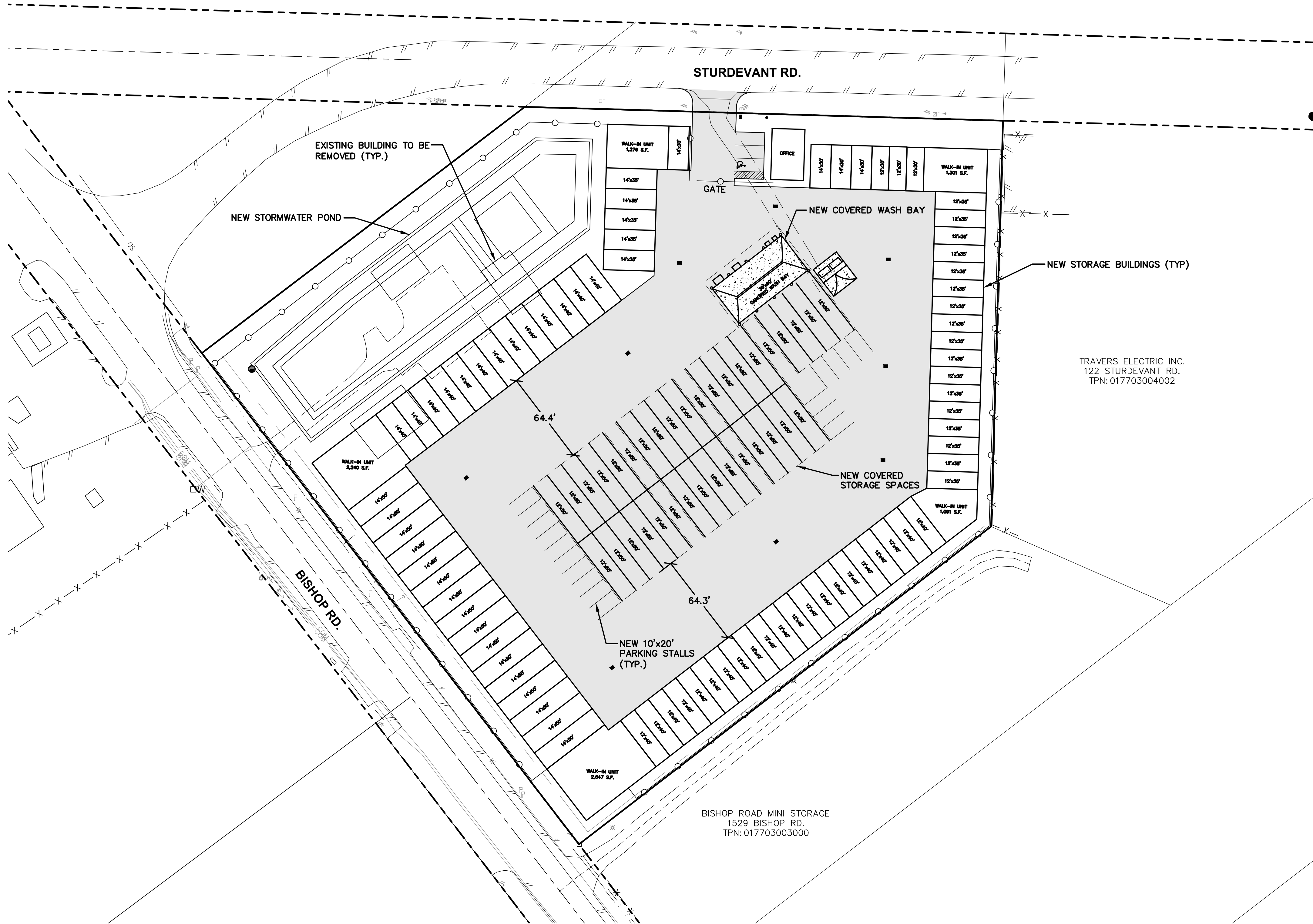

TRAVERS ELECTRIC INC.
122 STURDEVANT RD.
TPN: 017703004002

BISHOP ROAD MINI STORAGE
1529 BISHOP RD.
TPN: 017703003000

VICINITY MAP

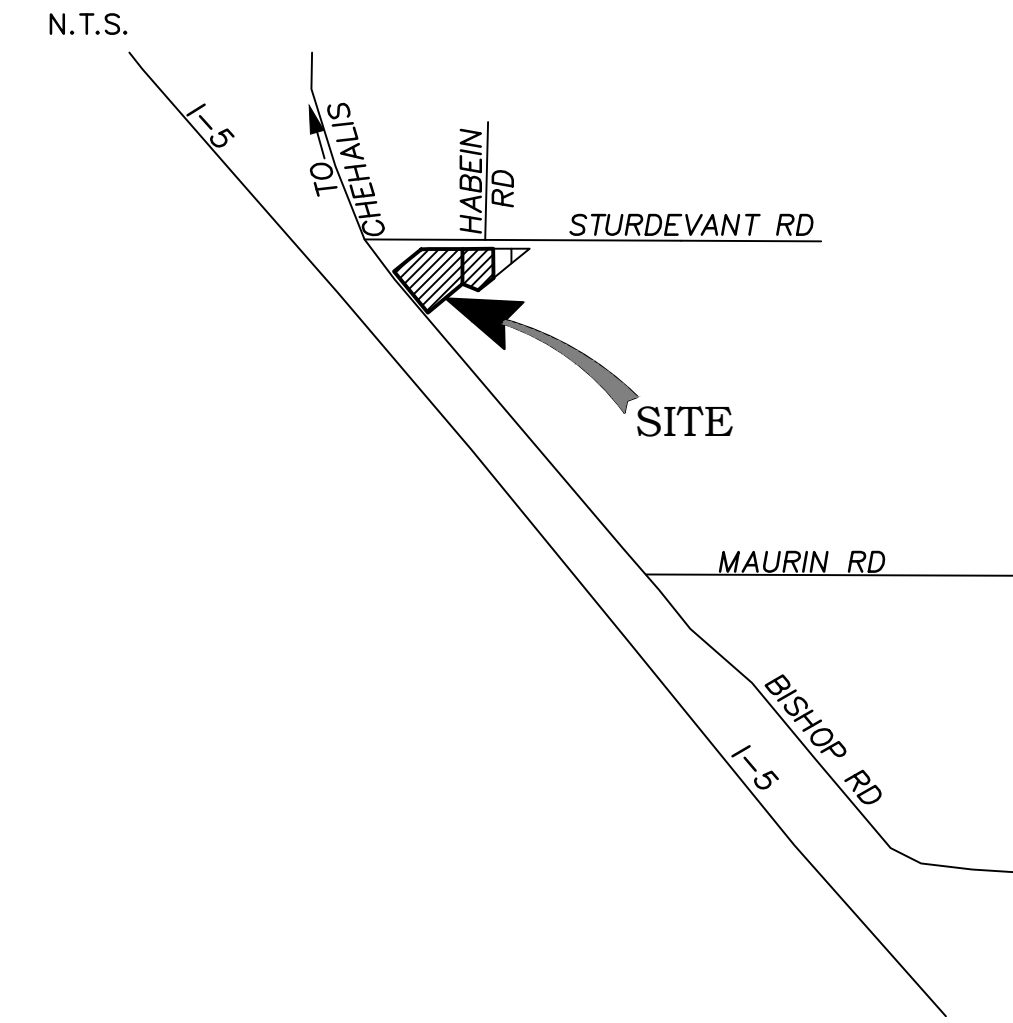

PROJECT INFORMATION

APPLICANT: RON TRAVERS
91 S.W. 13TH ST.
122 STURDEVANT RD
CHEHALIS, WA 98532
(360) 748-0059

ENGINEER: ROBERT W. BALMELLI
91 S.W. 13TH ST.
P.O. BOX 923
CHEHALIS, WA. 98532-0923
(360) 740-8919 PHONE
(360) 740-8912 FAX

SURVEYOR: BLUHM AND ASSOCIATES
1068 S MARKET BLVD.
CHEHALIS, WA 98532
(360) 748-1551

PARCEL NOS: 017703004001
SITE ADDRESS: 110 STURDEVANT RD
CHEHALIS, WA 98532

LAND USE APPROVAL: SPR
SEPA CHECKLIST: YES
CRITICAL AREAS: NO
ZONING: LIGHT INDUSTRIAL/ GENERAL COMMERCIAL
SETBACKS: FRONT 10', BACK 0', ADJ. 3'
MAX. BLDG. HEIGHT: 50 FEET

TOTAL SITE AREA: 4.02 ACRES
EXISTING IMPERVIOUS: 0.17 ACRES (4%)
NEW IMPERVIOUS: 3.25 ACRES
REPLACED IMPERVIOUS: 0.17 ACRES
NEW+REPLACED IMPERV.: 3.42 ACRES (85%)
LANDSCAPE AREA: 0.6 ACRES
TOTAL DISTURBED AREA: 4.02 ACRES
STREET FRONTAGE: 415 LINEAR FEET

GRADING (CUT/FILL): ±1,690 CY CUT / ±23,200 CY FILL

STORMWATER REGS: 2019 SWMMWW
SOIL CLASSIFICATION: NRCS
INFILTRATION: NO
TREATMENT: BASIC
FLOW CONTROL: DETENTION
NPDES STORM PERMIT: YES

DRIVEWAY WIDTH: 30' WIDE, MAX. ALLOWED = 30'

PARKING REQUIRED: 1 PER UNIT (89 STALLS)
ADA REQUIRED: 3 STALLS
PARKING PROVIDED: 19 STD. STALLS, 1 ADA STALLS
20 TOTAL STALLS

WATER SERVICE: CITY OF CHEHALIS (360) 748-0238
SEWER SERVICE: CITY OF CHEHALIS (360) 748-0238
FIRE DISTRICT: LC FIRE DISTRICT #6 (360) 748-0516
SCHOOL DISTRICT: CHEHALIS SCHOOL DISTRICT (360) 807-7200
POWER SERVICE: LEWIS COUNTY PUD (800) 562-5612

SHEET LIST

P0.1 OVERALL SITE PLAN
P1.1 PRELIMINARY GRADING AND DRAINAGE PLAN
P1.2 PRELIMINARY UTILITY PLAN
P1.3 PRELIMINARY DETAILS
P1.4 PRELIMINARY GRADING AND T.E.S.C. PLAN
LS1.1 PRELIMINARY LANDSCAPE PLAN

NO.	DATE	REVISION

DESIGNED BY: ZRW
DRAWN BY: CES
CHECKED BY: RB
DATE: 11/7/23
SCALE: 1" = 40'

SECURE TOY STORAGE
OVERALL SITE PLAN
LEWIS COUNTY, WA.

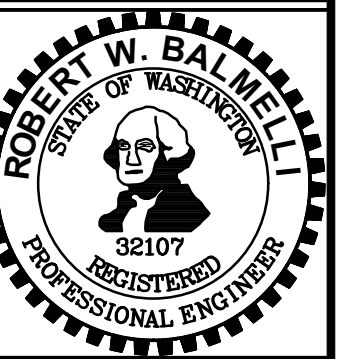

RB Engineering
DESIGN → PERMIT → MANAGE
P.O. Box 923
CHEHALIS, WA 98532
OFF: (360) 740-8919
EMAIL: info@rbengineers.com

811 Know what's below. Call 811 before you dig.
JOB NUMBER: 23036
DRAWING NAME: 23036_OVSP
P0.1
1 OF 6



SCALE: 1"=40 FEET
 0 20 40 80

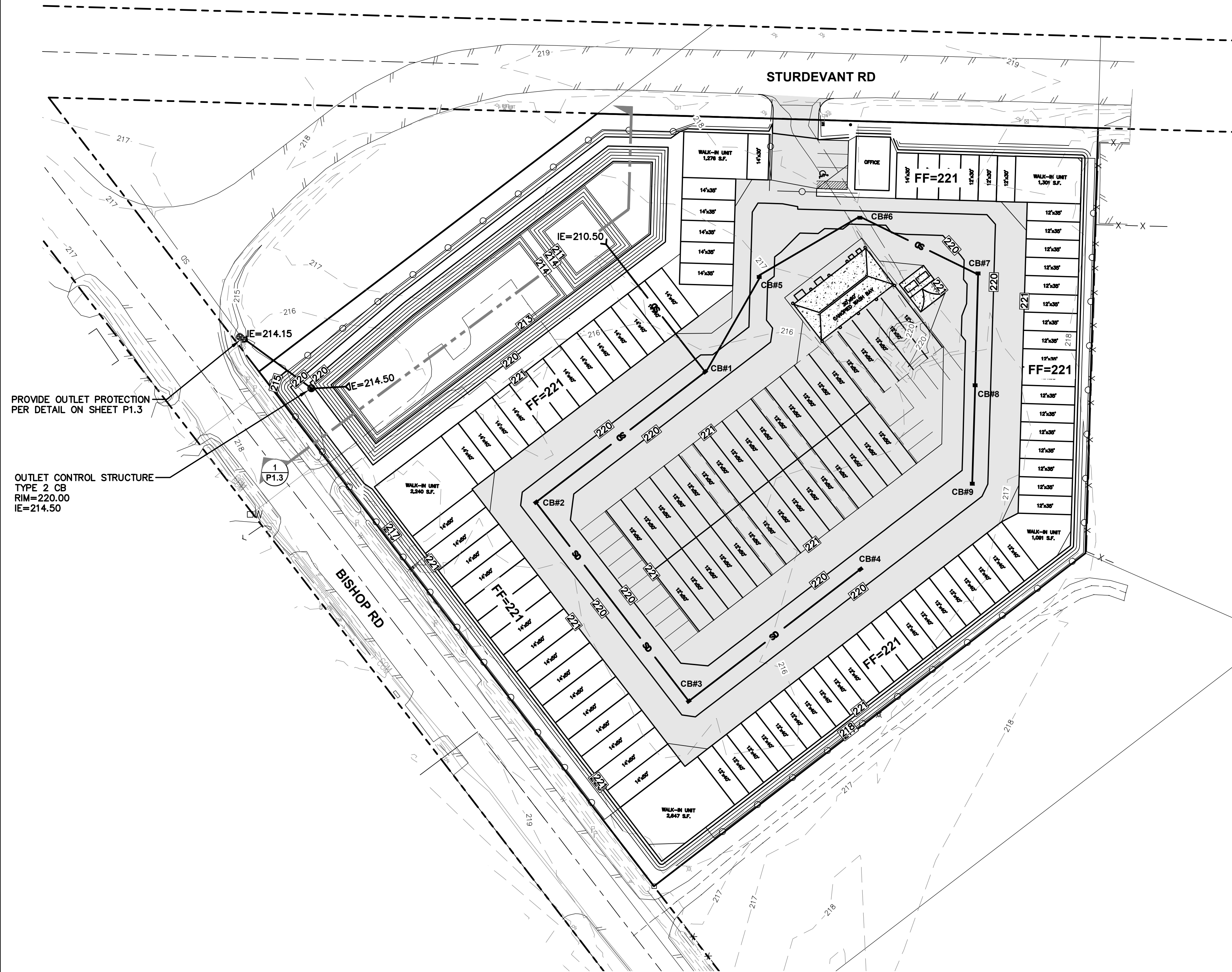

CATCH BASIN TABLE		
CB#	RIM	IE
1	218.32	214.32
2	219.00	215.00
3	219.50	215.81
4	219.50	216.50
5	219.00	215.06
6	219.50	215.43
7	219.50	215.84
8	219.50	216.19
9	219.50	216.5

NO.	DATE	REVISION

DESIGNED BY: ZRW
 DRAWN BY: CES
 CHECKED BY: RB
 DATE: 11/7/23
 SCALE: 1" = 40'

SECURE TOY STORAGE
 LEWIS COUNTY, WA.

PRELIMINARY GRADING
 AND DRAINAGE PLAN



RB Engineering
 DESIGN → PERMIT → MANAGE
 P.O. Box 923
 CHEHALIS, WA 98532
 OFF: (360) 740-8919
 EMAIL: info@rbengineers.com

811 Know what's below. Call 811 before you dig.

JOB NUMBER
 23036
 DRAWING NAME
 23036_PGDDR
P1.1
 2 OF 6

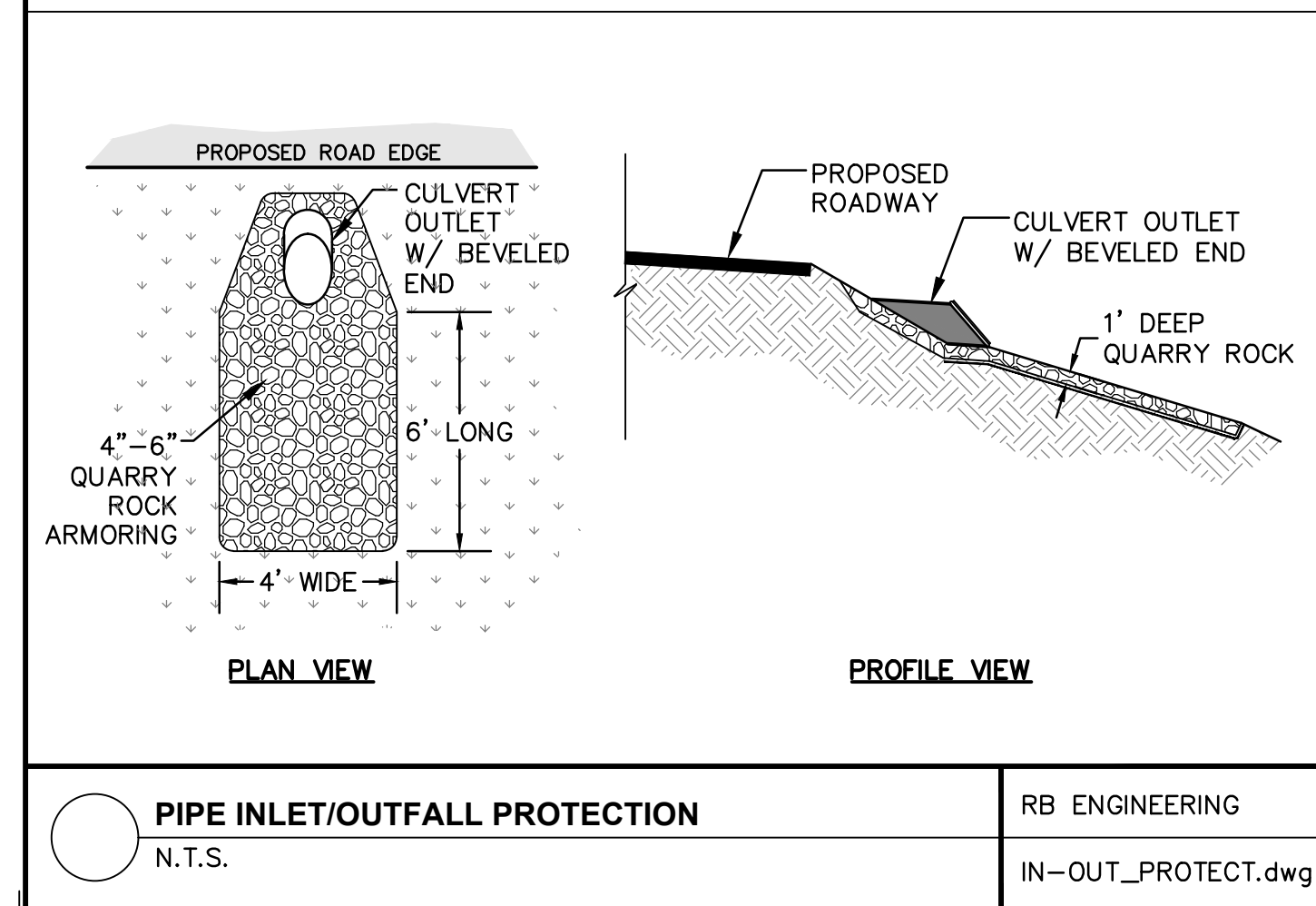
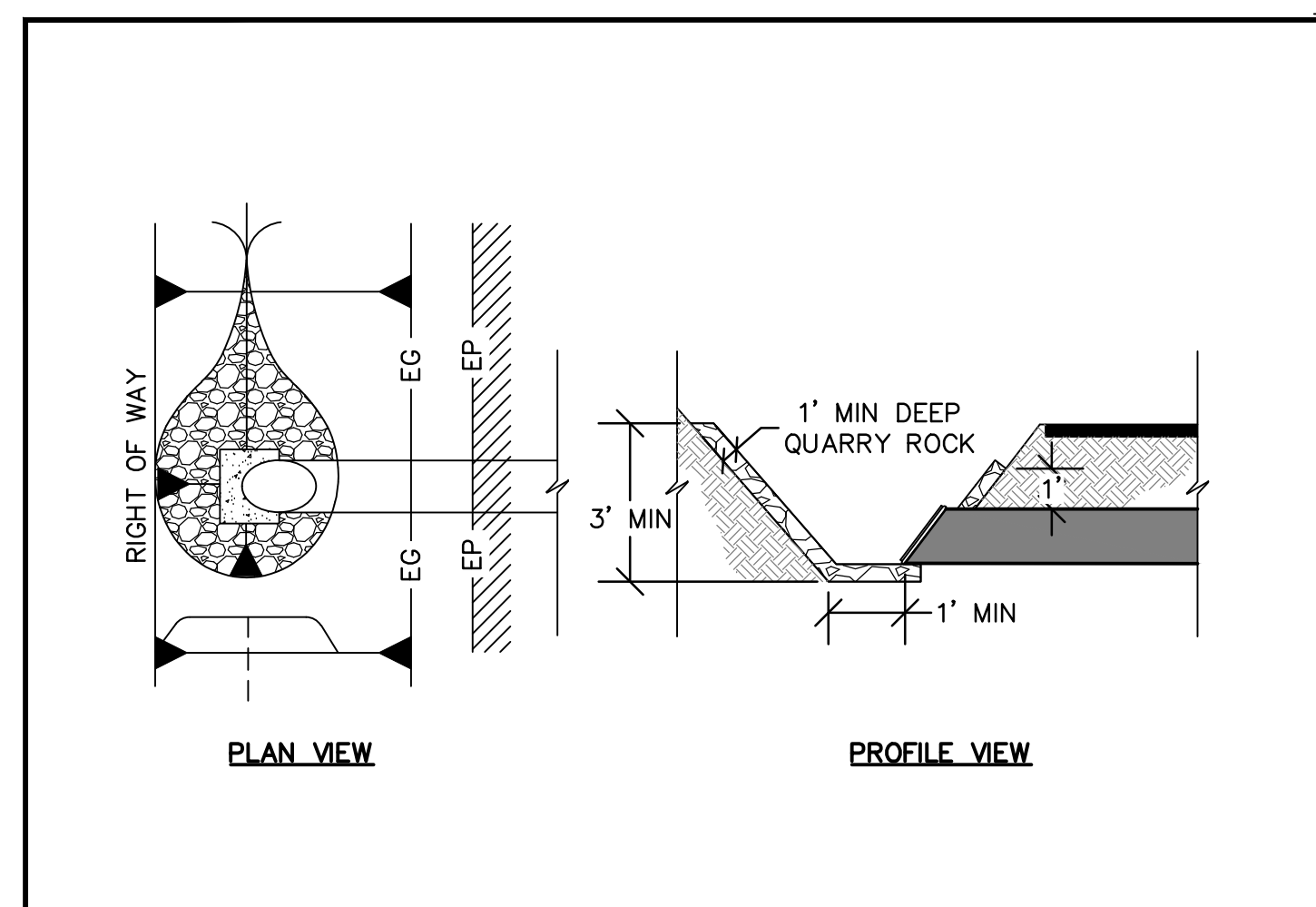
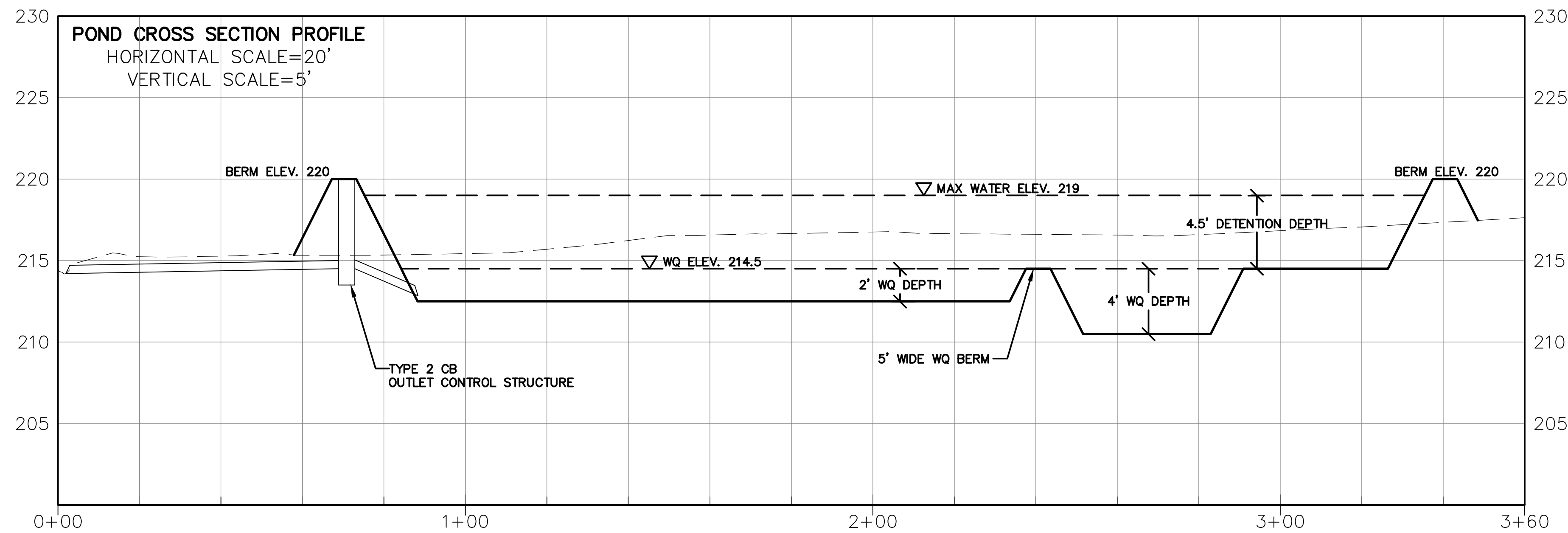

PIPE INLET/OUTFALL PROTECTION
 N.T.S.
 RB ENGINEERING
 IN-OUT_PROTECT.dwg

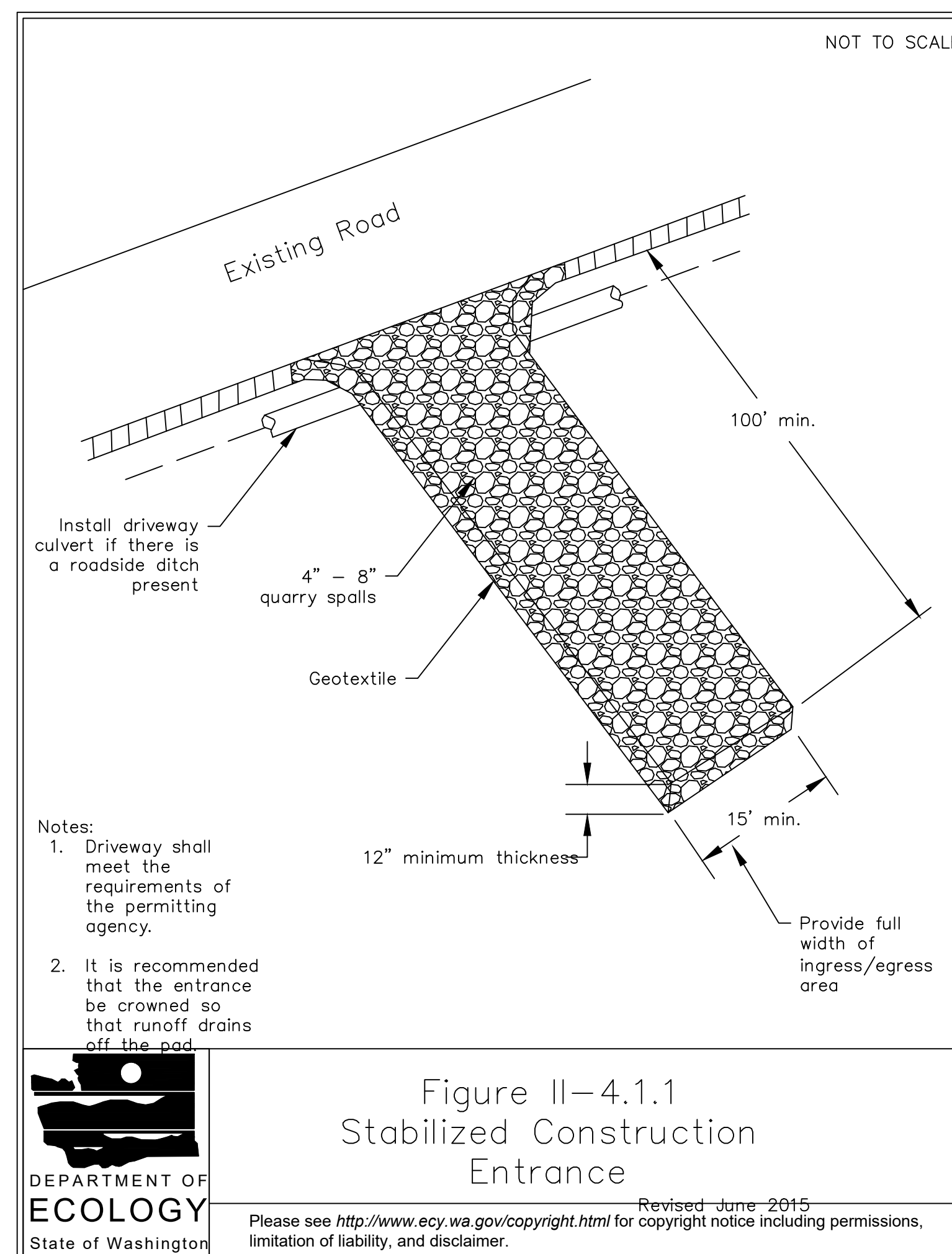

Figure II-4.1.1
 Stabilized Construction Entrance

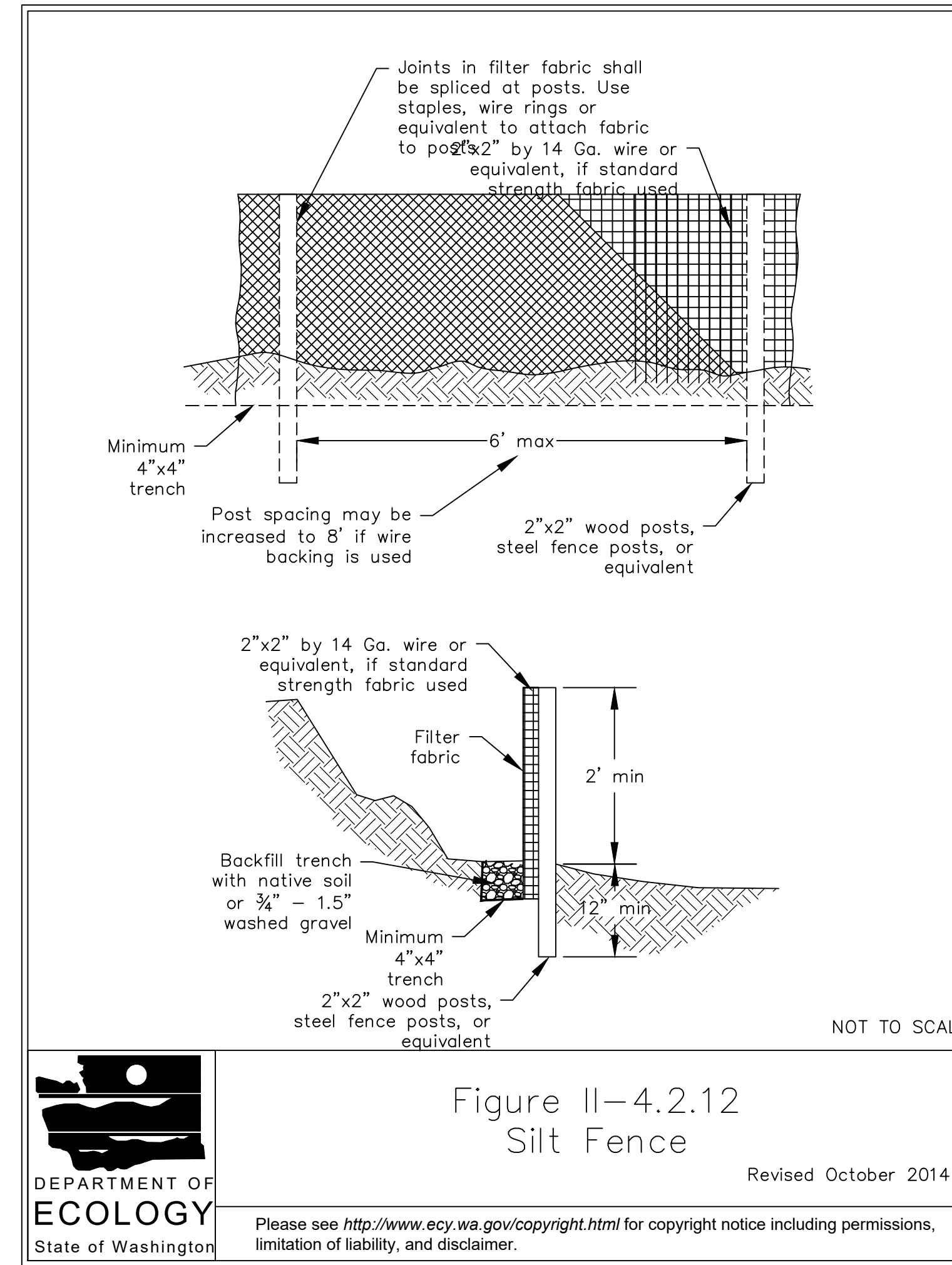

Figure II-4.2.12
 Silt Fence

NO.	DATE	REVISION

DESIGNED BY: ZRW
 DRAWN BY: CES
 CHECKED BY: RB
 DATE: 11/7/23
 SCALE: 1" = 40'

SECURE TOY STORAGE
 LEWIS COUNTY, WA.

PRELIMINARY DETAILS

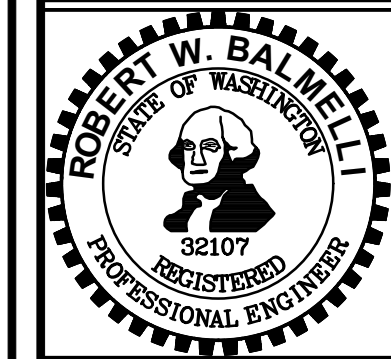

RB Engineering
 DESIGN - PERMIT - MANAGE
 OFF: (360) 740-8919
 EMAIL: info@rbengineers.com
 P.O. Box 923
 CHEHALIS, WA 98532

811 Know what's below. Call 811 before you dig.
 JOB NUMBER
 23036
 DRAWING NAME
 23036_PDT
P1.3
 4 OF 6



SCALE: 1"=40 FEET
0 20 40 80

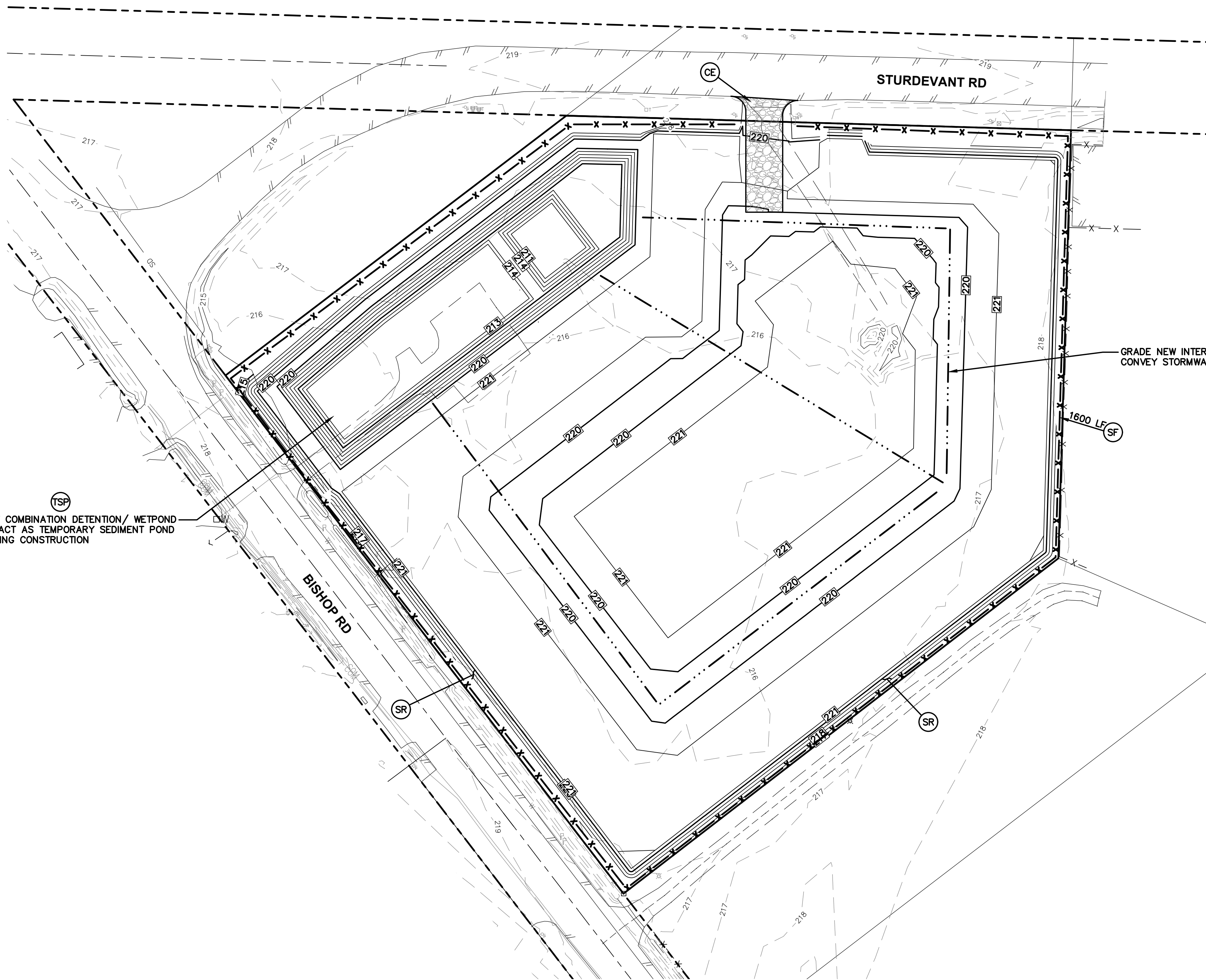

WSDOE BMP LIST:

- (CE) STABILIZED CONSTRUCTION ENTRANCE-EXIT - BMP C105
- (SR) SURFACE ROUGHENING - BMP C130
- (ID) INTERCEPTOR DITCH - BMP C200
- (SF) SILT FENCE - BMP C233
- (TSP) TEMPORARY SEDIMENT POND - BMP C241

NO.	DATE	REVISION

DESIGNED BY: ZRW
 DRAWN BY: CES
 CHECKED BY: RB
 DATE: 11/7/23
 SCALE: 1" = 40'

SECURE TOY STORAGE
 LEWIS COUNTY, WA.

PRELIMINARY GRADING
 AND T.E.S.C. PLAN



RB Engineering
 DESIGN -> PERMIT -> MANAGE
 P.O. Box 923
 CHEHALIS, WA 98532
 OFF: (360) 740-8919
 EMAIL: info@rbengineers.com

811 Know what's below. Call 811 before you dig.

JOB NUMBER
23036
 DRAWING NAME
23036_PTESC
P1.4
 5 OF 6

SECURE TOY STORAGE

SECTION 09, TOWNSHIP 13 NORTH, RANGE 02 WEST, W.M.
LEWIS COUNTY, WASHINGTON



SCALE: 1"=30 FEET
0 15 30 60

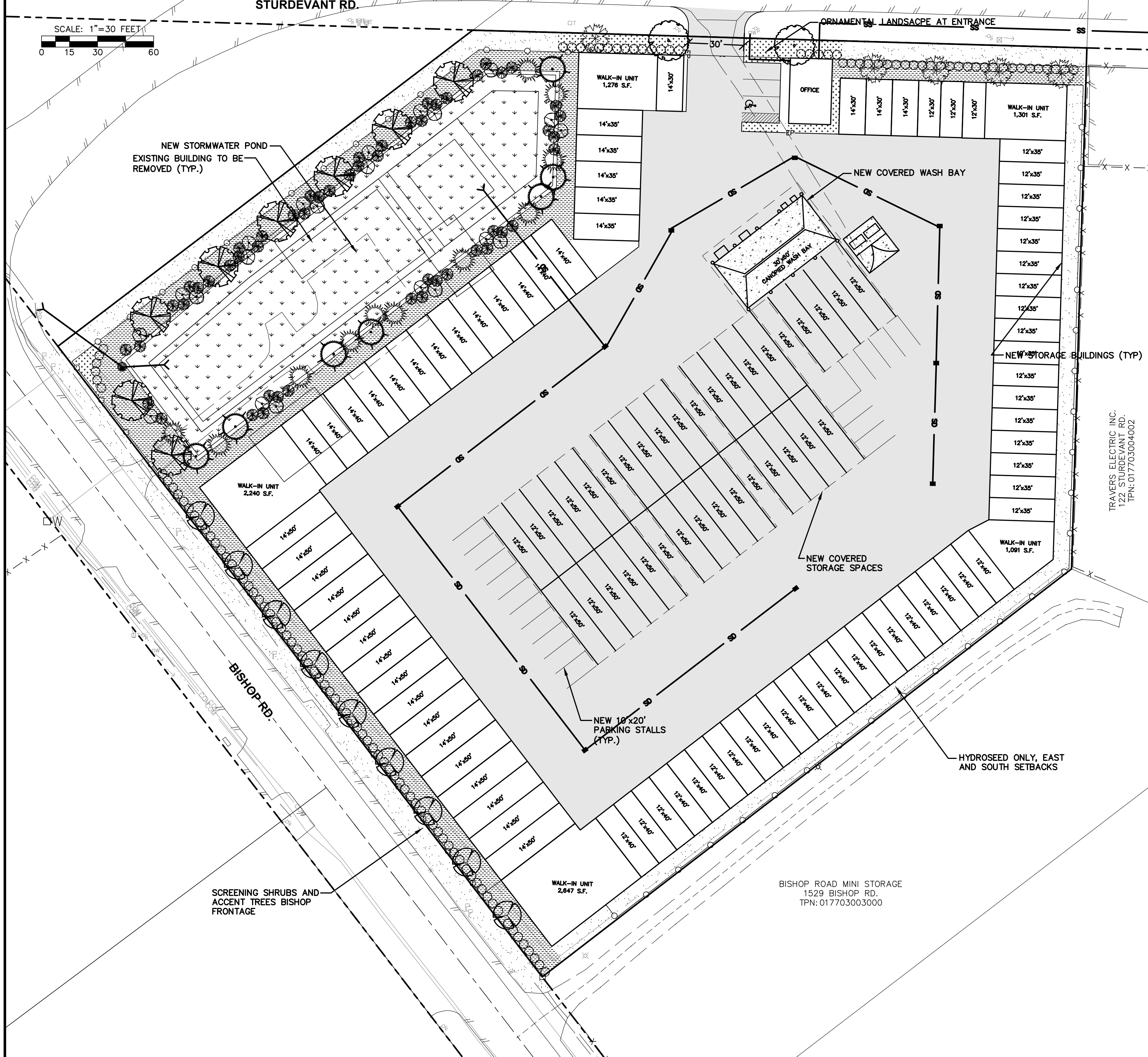

PRELIMINARY PLANT SCHEDULE

SYMBOL	QTY*	BOTANICAL NAME	COMMON NAME	SIZE	SPACING (NOTES)
	18-20	UTILITY STREET TREE <i>Cercis canadensis</i> <i>Malus spp.</i> <i>Acer truncatum x. platanoides</i> <i>Styrax japonicus</i> <i>Acer ginnala 'Flame'</i> <i>Fraxinum oxycarpa 'Aureofolia'</i>	Eastern Redbud Flowering Crabapple Norwegian Maple Japanese Snowbell Amur 'Flame' Maple Golden Desert Ash	2" CAL. MIN.	B&B/cont. 45' O.C.
	6-8	ACCENT TREES <i>Magnolia</i> <i>Acer circinatum</i> <i>Cercicophyllum japonicum</i> <i>Betula p. 'Jaquemontii'</i>	'Wada's Memory' Magnolia Vine Maple Green Japanese Maple Katsura Tree 'Jaquemontii' Birch	2" CAL. MIN.	B&B/cont.
	18-20	EVERGREEN TREES <i>Pseudotsuga menziesii</i> <i>Thuja plicata</i> <i>Abies koronensis</i> <i>Pinus thunbergiana</i> <i>Picea abies</i>	Douglas Fir Western Red Cedar Korean Fir Japanese Black Pine Serbian Spruce	7-8' HT. MIN.	B&B/cont.
	8-10	PERIMETER ACCENT SHRUBS <i>Photinia x fraseri</i> <i>Myrica californica</i>	Evergreen Photinia Pacific Wax Myrtle	5 GAL.	30' O.C.
	TBD	ORNAMENTAL PLANTINGS <i>Nandina Domestic</i> <i>Prunus laurocerasus</i> <i>Spiraea x. bumalda</i> <i>Pieris japonica</i>	Heavenly Bamboo 'Otto Luyken' Laurel Cold Mound Spirea 'Lilly Of The Valley' Shrub	3 GAL.	(3)/800SF
	~120	SCREENING SHRUBS <i>Thuja occidentalis</i> <i>Euonymus alata 'Compacta'</i> <i>Ilex crenata</i>	Emerald Green Arborvitae Dwarf Burning Bush Japanese Holly	5 GAL.	5' O.C.
		LOW MAINTENANCE GROUNDCOVER <i>Cotoneaster dammerii</i> <i>Viburnum davidii</i> <i>Euonymus fortunei</i> <i>Archostaphylos uva-ursi</i>	Bearberry David's Viburnum 'Emerald Gaiety' Euonymus Kinnickinnick		
		STORMPOND NATIVE SHRUBS <i>Salix x purpurea</i> <i>Physocarpus capitatus</i> <i>Mahonia aquifolia</i> <i>Symphoricarpos alba</i>	Arctic Willow Ninebark Oregon Grape Snowberry		
		SEEDED TURF AREA Provide permanent erosion control mixture, 6 way rye/fescue mix.			
		WETPOND SEED MIX Seed or specie mix as required by the Drainage Manual			

PRELIMINARY PLANTING PLAN NOTES:

- PRELIMINARY QUANTITY BASED ON MINIMUM CODE REQUIREMENTS. THE FINAL LANDSCAPE PLAN SHALL BE REVIEWED AND APPROVED ILLUSTRATING THE ACTUAL LANDSCAPE PLANT MATERIALS PROPOSED FOR CONSTRUCTION INCLUDING INSTALLATION DETAILS AND SPECIFICATIONS.
- SOME SCREENING MATERIAL IS NOT REQUIRED BY CODE
- FINAL LANDSCAPE INSTALLATION SHALL HAVE PROVISIONS FOR WATERING OR IRRIGATING LANDSCAPED AREAS.
- PRELIMINARY AREA TAKE OFF ESTIMATE:
ORNAMENTAL PLANTING: 1,000 S.F.
LOW MAINTENANCE G.C.: 15,280 S.F.
SEEDED AREA: 16,500 S.F.
WET POND AREA: 18,500 S.F.
TOTAL LANDSCAPE AREA TO PREP: 51,280 SQUARE FEET
EDGING SPEC: (T.B.D.)

NO.	DATE	DESIGNED BY: <u>CLA</u>	DRAWN BY: <u>CLA</u>	CHECKED BY: <u>RB</u>	DATE: <u>10/5/23</u>	SCALE: <u>1" = 30'</u>
SECURE TOY STORAGE						
PRELIMINARY LANDSCAPE PLAN						
RB Engineering DESIGN → PERMIT → MANAGE P.O. Box 923 CHEHALIS, WA 98532 OFF: (360) 740-8819 EMAIL: info@rbengineers.com						
JOB NUMBER 23036 DRAWING NAME 23036_LSPL LS1.1 6 OF 6						