

# ELEVATION CERTIFICATE

RECEIVED 8-2-13

OMB No. 1660-0008  
 Expiration Date: July 31, 2015

**Important: Read the instructions on pages 1-9.**

## SECTION A - PROPERTY INFORMATION

FOR INSURANCE COMPANY USE  
 Policy Number:  
 Company NAIC Number:

A1. Building Owner's Name **JOSE GONZALEZ**  
 A2. Building Street Address (including Apt., Unit, Suite, and/or Bldg. No.) or P.O. Route and Box No.  
**398 SW NEWAUKUM AVE.**  
 City **CHEHALIS** State **WA** ZIP Code **98532**

A3. Property Description (Lot and Block Numbers, Tax Parcel Number, Legal Description, etc.)  
**LEWIS COUNTY PARC. NO.005837000000**

A4. Building Use (e.g., Residential, Non-Residential, Addition, Accessory, etc.) **RESIDENTIAL**  
 A5. Latitude/Longitude: Lat. **N 46°39'17.1"** Long. **W 122°58'43.2"** Horizontal Datum:  NAD 1927  NAD 1983

A6. Attach at least 2 photographs of the building if the Certificate is being used to obtain flood insurance.

A7. Building Diagram Number **7**

A8. For a building with a crawlspace or enclosure(s):  
 a) Square footage of crawlspace or enclosure(s) **1490** sq ft  
 b) Number of permanent flood openings in the crawlspace or enclosure(s) within 1.0 foot above adjacent grade **20**  
 c) Total net area of flood openings in A8.b **3900** sq in  
 d) Engineered flood openings?  Yes  No

A9. For a building with an attached garage:  
 a) Square footage of attached garage **NA** sq ft  
 b) Number of permanent flood openings in the attached garage within 1.0 foot above adjacent grade **NA**  
 c) Total net area of flood openings in A9.b **NA** sq in  
 d) Engineered flood openings?  Yes  No

## SECTION B - FLOOD INSURANCE RATE MAP (FIRM) INFORMATION

B1. NFIP Community Name & Community Number <b>CHEHALIS 530104</b>		B2. County Name <b>LEWIS</b>		B3. State <b>WA</b>	
B4. Map/Panel Number <b>530104 1363</b>	B5. Suffix <b>C</b>	B6. FIRM Index Date <b>07/17/2006</b>	B7. FIRM Panel Effective/Revised Date <b>07/16/2006</b>	B8. Flood Zone(s) <b>AE</b>	B9. Base Flood Elevation(s) (Zone AO, use base flood depth) <b>181.7</b>

B10. Indicate the source of the Base Flood Elevation (BFE) data or base flood depth entered in Item B9.  
 FIS Profile  FIRM  Community Determined  Other/Source: \_\_\_\_\_

B11. Indicate elevation datum used for BFE in Item B9:  NGVD 1929  NAVD 1988  Other/Source: \_\_\_\_\_

B12. Is the building located in a Coastal Barrier Resources System (CBRS) area or Otherwise Protected Area (OPA)?  Yes  No  
 Designation Date: \_\_\_\_\_  CBRS  OPA

## SECTION C - BUILDING ELEVATION INFORMATION (SURVEY REQUIRED)

C1. Building elevations are based on:  Construction Drawings\*  Building Under Construction\*  Finished Construction  
 \*A new Elevation Certificate will be required when construction of the building is complete.

C2. Elevations - Zones A1-A30, AE, AH, A (with BFE), VE, V1-V30, V (with BFE), AR, AR/A, AR/AE, AR/A1-A30, AR/AH, AR/AO. Complete Items C2.a-h below according to the building diagram specified in Item A7. In Puerto Rico only, enter meters.  
 Benchmark Utilized: **SC1153** Vertical Datum: **NGVD 29**  
 Indicate elevation datum used for the elevations in items a) through h) below.  NGVD 1929  NAVD 1988  Other/Source: \_\_\_\_\_  
 Datum used for building elevations must be the same as that used for the BFE.

Check the measurement used.

a) Top of bottom floor (including basement, crawlspace, or enclosure floor)	<b>177.2</b>	<input checked="" type="checkbox"/> feet <input type="checkbox"/> meters
b) Top of the next higher floor	<b>185.1</b>	<input checked="" type="checkbox"/> feet <input type="checkbox"/> meters
c) Bottom of the lowest horizontal structural member (V Zones only)	<b>NA</b>	<input type="checkbox"/> feet <input type="checkbox"/> meters
d) Attached garage (top of slab)	<b>NA</b>	<input type="checkbox"/> feet <input type="checkbox"/> meters
e) Lowest elevation of machinery or equipment servicing the building (Describe type of equipment and location in Comments)	<b>185.1</b>	<input checked="" type="checkbox"/> feet <input type="checkbox"/> meters
f) Lowest adjacent (finished) grade next to building (LAG)	<b>177.1</b>	<input checked="" type="checkbox"/> feet <input type="checkbox"/> meters
g) Highest adjacent (finished) grade next to building (HAG)	<b>181.2</b>	<input checked="" type="checkbox"/> feet <input type="checkbox"/> meters
h) Lowest adjacent grade at lowest elevation of deck or stairs, including structural support	<b>179.5</b>	<input type="checkbox"/> feet <input type="checkbox"/> meters

## SECTION D - SURVEYOR, ENGINEER, OR ARCHITECT CERTIFICATION

This certification is to be signed and sealed by a land surveyor, engineer, or architect authorized by law to certify elevation information. I certify that the information on this Certificate represents my best efforts to interpret the data available. I understand that any false statement may be punishable by fine or imprisonment under 18 U.S. Code, Section 1001.

Check here if comments are provided on back of form. Were latitude and longitude in Section A provided by a licensed land surveyor?  Yes  No  
 Check here if attachments.

Certifier's Name **KENNETH L. FRAZIER** License Number **16908**  
 Title **Prof. Land Surveyor** Company Name **Foresight Surveying, Inc.**  
 Address **1583 N. National Ave.** City **Chehalis** State **WA** ZIP Code **98532**  
 Signature *Kenneth L. Frazier* Date **07/24/2013** Telephone **360-748-4000**

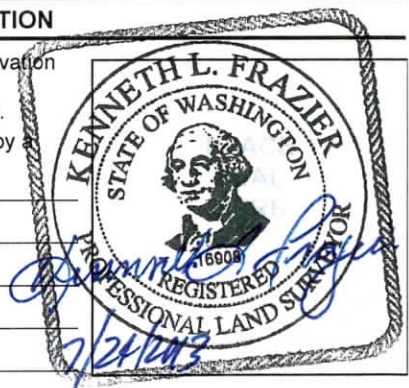

<b>IMPORTANT: In these spaces, copy the corresponding information from Section A.</b>	<b>FOR INSURANCE COMPANY USE</b>
Building Street Address (including Apt., Unit, Suite, and/or Bldg. No.) or P.O. Route and Box No. 398 SW NEWAUKUM AVE.	Policy Number:
City CHEHALIS State WA ZIP Code 98532	Company NAIC Number:

**SECTION D – SURVEYOR, ENGINEER, OR ARCHITECT CERTIFICATION (CONTINUED)**

Copy both sides of this Elevation Certificate for (1) community official, (2) insurance agent/company, and (3) building owner.

Comments THIS IS A WOOD FRAME TWO-STORY STRUCTURE ELEVATED ON A FULL-STORY ENGINEERED FOUNDATION WITH FLOOR AT OR ABOVE THE OUTSIDE GRADE ON A LEAST ONE SIDE. THE VENTS ARE ALL WITHIN THE 1 FOOT ABOVE THE OUTSIDE OR INSIDE GRADE. THE BASE FLOOD ELEVATION WAS PROVIDED BY THE COMMUNITY DEVELOPMENT DEPT. (THE BFE BY THE FIRM MAP WOULD BE 181 FEET")

Signature \_\_\_\_\_ Date 07/24/2013

**SECTION E – BUILDING ELEVATION INFORMATION (SURVEY NOT REQUIRED) FOR ZONE AO AND ZONE A (WITHOUT BFE)**

For Zones AO and A (without BFE), complete Items E1–E5. If the Certificate is intended to support a LOMA or LOMR-F request, complete Sections A, B, and C. For Items E1–E4, use natural grade, if available. Check the measurement used. In Puerto Rico only, enter meters.

- E1. Provide elevation information for the following and check the appropriate boxes to show whether the elevation is above or below the highest adjacent grade (HAG) and the lowest adjacent grade (LAG).
  - a) Top of bottom floor (including basement, crawlspace, or enclosure) is \_\_\_\_\_  feet  meters  above or  below the HAG.
  - b) Top of bottom floor (including basement, crawlspace, or enclosure) is \_\_\_\_\_  feet  meters  above or  below the LAG.
- E2. For Building Diagrams 6–9 with permanent flood openings provided in Section A Items 8 and/or 9 (see pages 8–9 of Instructions), the next higher floor (elevation C2.b in the diagrams) of the building is \_\_\_\_\_  feet  meters  above or  below the HAG.
- E3. Attached garage (top of slab) is \_\_\_\_\_  feet  meters  above or  below the HAG.
- E4. Top of platform of machinery and/or equipment servicing the building is \_\_\_\_\_  feet  meters  above or  below the HAG.
- E5. Zone AO only: If no flood depth number is available, is the top of the bottom floor elevated in accordance with the community's floodplain management ordinance?  Yes  No  Unknown. The local official must certify this information in Section G.

**SECTION F – PROPERTY OWNER (OR OWNER'S REPRESENTATIVE) CERTIFICATION**

The property owner or owner's authorized representative who completes Sections A, B, and E for Zone A (without a FEMA-issued or community-issued BFE) or Zone AO must sign here. The statements in Sections A, B, and E are correct to the best of my knowledge.

Property Owner's or Owner's Authorized Representative's Name \_\_\_\_\_

Address _____	City _____	State _____	ZIP Code _____
Signature _____	Date 3 _____	Telephone _____	

Comments \_\_\_\_\_

Check here if attachments

**SECTION G – COMMUNITY INFORMATION (OPTIONAL)**

The local official who is authorized by law or ordinance to administer the community's floodplain management ordinance can complete Sections A, B, C (or E), and G of this Elevation Certificate. Complete the applicable item(s) and sign below. Check the measurement used in Items G8–G10. In Puerto Rico only, enter meters.

- G1.  The information in Section C was taken from other documentation that has been signed and sealed by a licensed surveyor, engineer, or architect who is authorized by law to certify elevation information. (Indicate the source and date of the elevation data in the Comments area below.)
- G2.  A community official completed Section E for a building located in Zone A (without a FEMA-issued or community-issued BFE) or Zone AO.
- G3.  The following information (Items G4–G10) is provided for community floodplain management purposes.

G4. Permit Number _____	G5. Date Permit Issued _____	G6. Date Certificate Of Compliance/Occupancy Issued _____
-------------------------	------------------------------	---

- G7. This permit has been issued for:  New Construction  Substantial Improvement
- G8. Elevation of as-built lowest floor (including basement) of the building: \_\_\_\_\_  feet  meters Datum \_\_\_\_\_
- G9. BFE or (in Zone AO) depth of flooding at the building site: \_\_\_\_\_  feet  meters Datum \_\_\_\_\_
- G10. Community's design flood elevation: \_\_\_\_\_  feet  meters Datum \_\_\_\_\_

Local Official's Name _____	Title _____
Community Name _____	Telephone _____
Signature _____	Date _____

Comments \_\_\_\_\_

Check here if attachments



# Building Photographs

See Instructions for Item A6.

**IMPORTANT: In these spaces, copy the corresponding information from Section A.**

FOR INSURANCE COMPANY USE

Building Street Address (including Apt., Unit, Suite, and/or Bldg. No.) or P.O. Route and Box No.  
398 SW NEWAUKUM AVE.

Policy Number:

City CHEHALIS

State WA ZIP Code 98532

Company NAIC Number:

If using the Elevation Certificate to obtain NFIP flood insurance, affix at least 2 building photographs below according to the instructions for Item A6. Identify all photographs with date taken; "Front View" and "Rear View"; and, if required, "Right Side View" and "Left Side View." When applicable, photographs must show the foundation with representative examples of the flood openings or vents, as indicated in Section A8. If submitting more photographs than will fit on this page, use the Continuation Page.



FRONT VIEW FROM SW



FRONT VIEW FROM NW



SOUTH VIEW



REAR VIEW FROM EAST SIDE



# Building Photographs

Continuation Page

**IMPORTANT: In these spaces, copy the corresponding information from Section A.**

Building Street Address (including Apt., Unit, Suite, and/or Bldg. No.) or P.O. Route and Box No.  
398 SW NEWAUKUM AVE.

City CHEHALIS

State WA

ZIP Code 98532

FOR INSURANCE COMPANY USE

Policy Number:

Company NAIC Number:

If submitting more photographs than will fit on the preceding page, affix the additional photographs below. Identify all photographs with: date taken; "Front View" and "Rear View"; and, if required, "Right Side View" and "Left Side View." When applicable, photographs must show the foundation with representative examples of the flood openings or vents, as indicated in Section A8.



TYPICAL VENT



CRAWL SPACE



CRAWL SPACE ACCESS  
(SCREENED DOOR TO THE RIGHT WILL BE INSTALLED)