

11/9/18  
Actual address is:  
345 W. Main  
OK

FEDERAL EMERGENCY MANAGEMENT AGENCY  
NATIONAL FLOOD INSURANCE PROGRAM

O.M.B. No. 3067-0077  
Expires December 31, 2005

ELEVATION CERTIFICATE

Important: Read the instructions on pages 1 - 7.

SECTION A - PROPERTY OWNER INFORMATION		For Insurance Company Use:
BUILDING OWNER'S NAME <u>LEWIS COUNTY</u>		Policy Number
BUILDING STREET ADDRESS (Including Apt., Unit, Suite, and/or Bldg. No.) OR P.O. ROUTE AND BOX NO. <u>28 SW CHEHALIS AVE</u>		Company NAIC Number
CITY <u>CHEHALIS</u>	STATE <u>WA</u>	ZIP CODE <u>98532</u>
PROPERTY DESCRIPTION (Lot and Block Numbers, Tax Parcel Number, Legal Description, etc.) <u>NW 1/4 - NW 1/4 SEC 32 - Twp 14N - R6E 2W - W</u>		
BUILDING USE (e.g., Residential, Non-residential, Addition, Accessory, etc. Use a Comments area, if necessary.) <u>JAIL</u>		
LATITUDE/LONGITUDE (OPTIONAL) (##° - ##' - ###" or #####°)	HORIZONTAL DATUM: <input type="checkbox"/> NAD 1927 <input type="checkbox"/> NAD 1983	SOURCE: <input type="checkbox"/> GPS (Type): <input type="checkbox"/> USGS Quad Map <input type="checkbox"/> Other

SECTION B - FLOOD INSURANCE RATE MAP (FIRM) INFORMATION

B1. NFIP COMMUNITY NAME & COMMUNITY NUMBER <u>CITY OF CHEHALIS - 530104-0002</u>		B2. COUNTY NAME <u>LEWIS</u>		B3. STATE <u>WA</u>	
B4. MAP AND PANEL NUMBER <u>530104-0002 B</u>	B5. SUFFIX <u>B</u>	B6. FIRM INDEX DATE <u>5-1-80</u>	B7. FIRM PANEL EFFECTIVE/REVISED DATE	B8. FLOOD ZONE(S) <u>A6</u>	B9. BASE FLOOD ELEVATION(S) (Zone AO, use depth of flooding) <u>182</u>

B10. Indicate the source of the Base Flood Elevation (BFE) data or base flood depth entered in B9.

☐ FIS Profile ☒ FIRM ☐ Community Determined ☐ Other (Describe):

B11. Indicate the elevation datum used for the BFE in B9: ☒ NGVD 1929 ☐ NAVD 1988 ☐ Other (Describe):

B12. Is the building located in a Coastal Barrier Resources System (CBRS) area or Otherwise Protected Area (OPA)? ☐ Yes ☒ No  
Designation Date:

SECTION C - BUILDING ELEVATION INFORMATION (SURVEY REQUIRED)

C1. Building elevations are based on: ☐ Construction Drawings\* ☐ Building Under Construction\* ☒ Finished Construction  
\*A new Elevation Certificate will be required when construction of the building is complete.

C2. Building Diagram Number 1 (Select the building diagram most similar to the building for which this certificate is being completed - see pages 6 and 7. If no diagram accurately represents the building, provide a sketch or photograph.)

C3. Elevations - Zones A1-A30, AE, AH, A (with BFE), VE, V1-V30, V (with BFE), AR, AR/A, AR/AE, AR/A1-A30, AR/AH, AR/AO  
Complete Items C3.a-i below according to the building diagram specified in Item C2. State the datum used. If the datum is different from the datum used for the BFE in Section B, convert the datum to that used for the BFE. Show field measurements and datum conversion calculation. Use the space provided or the Comments area of Section D or Section G, as appropriate, to document the datum conversion.  
Datum NGVD Conversion/Comments

Elevation reference mark used EX 9 Does the elevation reference mark used appear on the map? NC

<input type="checkbox"/> a) Top of bottom floor (including basement or enclosure)	<u>185</u> <u>0</u> ft.(m)
<input type="checkbox"/> b) Top of next higher floor	<u>194</u> <u>5</u> ft.(m)
<input type="checkbox"/> c) Bottom of lowest horizontal structural member (V zones only)	<u>NA</u> ft.(m)
<input type="checkbox"/> d) Attached garage (top of slab)	<u>NA</u> ft.(m)
<input type="checkbox"/> e) Lowest elevation of machinery and/or equipment servicing the building (Describe in a Comments area.)	<u>NA</u> ft.(m)
<input type="checkbox"/> f) Lowest adjacent (finished) grade (LAG)	<u>181</u> <u>3</u> ft.(m)
<input type="checkbox"/> g) Highest adjacent (finished) grade (HAG)	<u>181</u> <u>182</u> <u>3</u> ft.(m)
<input type="checkbox"/> h) No. of permanent openings (flood vents) within 1 ft. above adjacent grade	<u>NA</u>
<input type="checkbox"/> i) Total area of all permanent openings (flood vents) in C3.h	<u>NA</u> sq. in. (sq. cm)

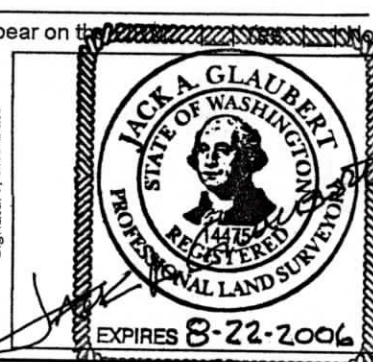

SECTION D - SURVEYOR, ENGINEER, OR ARCHITECT CERTIFICATION

This certification is to be signed and sealed by a land surveyor, engineer, or architect authorized by law to certify elevation information.  
I certify that the information in Sections A, B, and C on this certificate represents my best efforts to interpret the data available.  
I understand that any false statement may be punishable by fine or imprisonment under 18 U.S. Code, Section 1001.

CERTIFIER'S NAME <u>JACK A. GLAUBERT</u>		LICENSE NUMBER <u>L.S. 14475</u>	
TITLE <u>owner</u>	COMPANY NAME <u>Sound Surveyors Inc.</u>	STATE <u>WA</u>	ZIP CODE <u>98382</u>
ADDRESS <u>223 HARDWICK ROAD</u>	CITY <u>SEQUIM</u>	TELEPHONE <u>(360) 457-5422</u>	
SIGNATURE <u>Jack A. Glaubert</u>	DATE <u>5/3/2005</u>		

<b>IMPORTANT: In these spaces, copy the corresponding information from Section A.</b>		<b>For Insurance Company Use:</b>	
BUILDING STREET ADDRESS (Including Apt., Unit, Suite, and/or Bldg. No.) OR P.O. ROUTE AND BOX NO. 18 SW CHEHALIS AVE		Policy Number	
CITY CHEHALIS WA	STATE WA	ZIP CODE 98532	Company NAIC Number

### SECTION D - SURVEYOR, ENGINEER, OR ARCHITECT CERTIFICATION (CONTINUED)

Copy both sides of this Elevation Certificate for (1) community official, (2) insurance agent/company, and (3) building owner.

COMMENTS

ELEVATION 185.70 FOUND AT WEST END OF  
THE BOTTOM STEP OF LEWIS CO. COURT HOUSE  
4" BRASS DISC "NATIONAL GEODETIC BENCHMARK" EX 9"

☐ Check here if attachments

### SECTION E - BUILDING ELEVATION INFORMATION (SURVEY NOT REQUIRED) FOR ZONE AO AND ZONE A (WITHOUT BFE)

For Zone AO and Zone A (without BFE), complete Items E1. through E5. If the Elevation Certificate is intended for use as supporting information for a LOMA or LOMR-F, Section C must be completed.

- E1. Building Diagram Number \_\_\_\_\_ (Select the building diagram most similar to the building for which this certificate is being completed - see pages 6 and 7. If no diagram accurately represents the building, provide a sketch or photograph.)
- E2. The top of the bottom floor (including basement or enclosure) of the building is  ft. (m)  in. (cm) ☐ above or ☐ below (check one) the highest adjacent grade. (Use natural grade, if available.)
- E3. For Building Diagrams 6-8 with openings (see page 7), the next higher floor or elevated floor (elevation b) of the building is  ft. (m)  in. (cm) above the highest adjacent grade. Complete Items C3.h and C3.i on front of form.
- E4. The top of the platform of machinery and/or equipment servicing the building is  ft. (m)  in. (cm) ☐ above or ☐ below (check one) the highest adjacent grade. (Use natural grade, if available.)
- E5. For Zone AO only: If no flood depth number is available, is the top of the bottom floor elevated in accordance with the community's floodplain management ordinance? ☐ Yes ☐ No ☐ Unknown. The local official must certify this information in Section G.

### SECTION F - PROPERTY OWNER (OR OWNER'S REPRESENTATIVE) CERTIFICATION

The property owner or owner's authorized representative who completes Sections A, B, C (Items C3.h and C3.i only), and E for Zone A (without a FEMA-issued or community-issued BFE) or Zone AO must sign here. The statements in Sections A, B, C, and E are correct to the best of my knowledge.

PROPERTY OWNER'S OR OWNER'S AUTHORIZED REPRESENTATIVE'S NAME

ADDRESS	CITY	STATE	ZIP CODE
SIGNATURE	DATE	TELEPHONE	
COMMENTS			

☐ Check here if attachments

### SECTION G - COMMUNITY INFORMATION (OPTIONAL)

The local official who is authorized by law or ordinance to administer the community's floodplain management ordinance can complete Sections A, B, C (or E), and G of this Elevation Certificate. Complete the applicable item(s) and sign below.

- G1. ☐ The information in Section C was taken from other documentation that has been signed and embossed by a licensed surveyor, engineer, or architect who is authorized by state or local law to certify elevation information. (Indicate the source and date of the elevation data in the Comments area below.)
- G2. ☐ A community official completed Section E for a building located in Zone A (without a FEMA-issued or community-issued BFE) or Zone AO.
- G3. ☐ The following information (Items G4-G9) is provided for community floodplain management purposes.

G4. PERMIT NUMBER	G5. DATE PERMIT ISSUED	G6. DATE CERTIFICATE OF COMPLIANCE/OCCUPANCY ISSUED
-------------------	------------------------	---

G7. This permit has been issued for: ☐ New Construction ☐ Substantial Improvement

G8. Elevation of as-built lowest floor (including basement) of the building is: \_\_\_\_\_ ft. (m) Datum: \_\_\_\_\_

G9. BFE or (in Zone AO) depth of flooding at the building site is: \_\_\_\_\_ ft. (m) Datum: \_\_\_\_\_

LOCAL OFFICIAL'S NAME	TITLE
COMMUNITY NAME	TELEPHONE
SIGNATURE	DATE
COMMENTS	

☐ Check here if attachments