

JAN 30 2017 *aw*

OMB No. 1660-0008  
 Expiration Date: November 30, 2018

# ELEVATION CERTIFICATE

**Important:** Follow the instructions on pages 1-9.

Copy all pages of this Elevation Certificate and all attachments for (1) community official, (2) insurance agent/company, and (3) building owner.

| SECTION A – PROPERTY INFORMATION  |                 |                                   |  | FOR INSURANCE COMPANY USE |  |
|---|-----------------|-----------------------------------|--|---------------------------|--|
| A1. Building Owner's Name<br>NW Restaurants Inc.  |                 |                                   |  | Policy Number:            |  |
| A2. Building Street Address (including Apt., Unit, Suite, and/or Bldg. No.) or P.O. Route and Box No.<br>1755 NW LOUISIANA AVE.   |                 |                                   |  | Company NAIC Number:      |  |
| City<br>CHEHALIS  |                 | State<br>Washington               |  | ZIP Code<br>98532         |  |
| A3. Property Description (Lot and Block Numbers, Tax Parcel Number, Legal Description, etc.)<br>LEWIS COUNTY PARC. NO. 005605016001   |                 |                                   |  |                           |  |
| A4. Building Use (e.g., Residential, Non-Residential, Addition, Accessory, etc.) <u>COMMERCIAL RESTAURANT</u>   |                 |                                   |  |                           |  |
| A5. Latitude/Longitude: Lat. <u>N 46°40'50.2"</u> Long. <u>W 122°58'31.05</u> Horizontal Datum: <input type="checkbox"/> NAD 1927 <input checked="" type="checkbox"/> NAD 1983  |                 |                                   |  |                           |  |
| A6. Attach at least 2 photographs of the building if the Certificate is being used to obtain flood insurance.   |                 |                                   |  |                           |  |
| A7. Building Diagram Number <u>1B</u>   |                 |                                   |  |                           |  |
| A8. For a building with a crawlspace or enclosure(s):   |                 |                                   |  |                           |  |
| a) Square footage of crawlspace or enclosure(s) <u>0</u> sq ft  |                 |                                   |  |                           |  |
| b) Number of permanent flood openings in the crawlspace or enclosure(s) within 1.0 foot above adjacent grade <u>0</u>   |                 |                                   |  |                           |  |
| c) Total net area of flood openings in A8.b <u>0</u> sq in  |                 |                                   |  |                           |  |
| d) Engineered flood openings? <input type="checkbox"/> Yes <input checked="" type="checkbox"/> No   |                 |                                   |  |                           |  |
| A9. For a building with an attached garage:   |                 |                                   |  |                           |  |
| a) Square footage of attached garage <u>0</u> sq ft   |                 |                                   |  |                           |  |
| b) Number of permanent flood openings in the attached garage within 1.0 foot above adjacent grade <u>0</u>  |                 |                                   |  |                           |  |
| c) Total net area of flood openings in A9.b <u>0</u> sq in  |                 |                                   |  |                           |  |
| d) Engineered flood openings? <input type="checkbox"/> Yes <input checked="" type="checkbox"/> No   |                 |                                   |  |                           |  |
| SECTION B – FLOOD INSURANCE RATE MAP (FIRM) INFORMATION   |                 |                                   |  |                           |  |
| B1. NFIP Community Name & Community Number<br>CHEHALIS-530104   |                 |                                   | B2. County Name<br>LEWIS                             |                           | B3. State<br>Washington  |
| B4. Map/Panel Number<br>530104 1361   | B5. Suffix<br>C | B6. FIRM Index Date<br>07/17/2006 | B7. FIRM Panel Effective/ Revised Date<br>07/17/2006 | B8. Flood Zone(s)<br>AE   | B9. Base Flood Elevation(s) (Zone AO, use Base Flood Depth)<br>176.5 |
| B10. Indicate the source of the Base Flood Elevation (BFE) data or base flood depth entered in Item B9:<br><input checked="" type="checkbox"/> FIS Profile <input type="checkbox"/> FIRM <input type="checkbox"/> Community Determined <input type="checkbox"/> Other/Source: _____ |                 |                                   |  |                           |  |
| B11. Indicate elevation datum used for BFE in Item B9: <input checked="" type="checkbox"/> NGVD 1929 <input type="checkbox"/> NAVD 1988 <input type="checkbox"/> Other/Source: _____  |                 |                                   |  |                           |  |
| B12. Is the building located in a Coastal Barrier Resources System (CBRS) area or Otherwise Protected Area (OPA)? <input type="checkbox"/> Yes <input checked="" type="checkbox"/> No<br>Designation Date: _____ <input type="checkbox"/> CBRS <input type="checkbox"/> OPA         |                 |                                   |  |                           |  |

# ELEVATION CERTIFICATE

OMB No. 1660-0008  
Expiration Date: November 30, 2018

|   |                     |                   |                                  |
|---|---------------------|-------------------|----------------------------------|
| <b>IMPORTANT: In these spaces, copy the corresponding information from Section A.</b>                                       |                     |                   | <b>FOR INSURANCE COMPANY USE</b> |
| Building Street Address (including Apt., Unit, Suite, and/or Bldg. No.) or P.O. Route and Box No.<br>1755 NW LOUISIANA AVE. |                     |                   | Policy Number:                   |
| City<br>CHEHALIS  | State<br>Washington | ZIP Code<br>98532 | Company NAIC Number              |

## SECTION C – BUILDING ELEVATION INFORMATION (SURVEY REQUIRED)

C1. Building elevations are based on:  Construction Drawings\*  Building Under Construction\*  Finished Construction  
\*A new Elevation Certificate will be required when construction of the building is complete.

C2. Elevations – Zones A1–A30, AE, AH, A (with BFE), VE, V1–V30, V (with BFE), AR, AR/A, AR/AE, AR/A1–A30, AR/AH, AR/AO. Complete Items C2.a–h below according to the building diagram specified in Item A7. In Puerto Rico only, enter meters.

Benchmark Utilized: SC0207 Vertical Datum: NGVD 29

Indicate elevation datum used for the elevations in items a) through h) below.

NGVD 1929  NAVD 1988  Other/Source: \_\_\_\_\_

Datum used for building elevations must be the same as that used for the BFE.

Check the measurement used.

- |   |       |  |                                 |
|---|-------|--|---------------------------------|
| a) Top of bottom floor (including basement, crawlspace, or enclosure floor)   | 177.7 | <input checked="" type="checkbox"/> feet | <input type="checkbox"/> meters |
| b) Top of the next higher floor   | 0.    | <input checked="" type="checkbox"/> feet | <input type="checkbox"/> meters |
| c) Bottom of the lowest horizontal structural member (V Zones only)   | 0.    | <input checked="" type="checkbox"/> feet | <input type="checkbox"/> meters |
| d) Attached garage (top of slab)  | 0.    | <input checked="" type="checkbox"/> feet | <input type="checkbox"/> meters |
| e) Lowest elevation of machinery or equipment servicing the building<br>(Describe type of equipment and location in Comments) | 177.7 | <input checked="" type="checkbox"/> feet | <input type="checkbox"/> meters |
| f) Lowest adjacent (finished) grade next to building (LAG)  | 177.2 | <input checked="" type="checkbox"/> feet | <input type="checkbox"/> meters |
| g) Highest adjacent (finished) grade next to building (HAG)   | 177.6 | <input checked="" type="checkbox"/> feet | <input type="checkbox"/> meters |
| h) Lowest adjacent grade at lowest elevation of deck or stairs, including structural support                                  | 0.    | <input checked="" type="checkbox"/> feet | <input type="checkbox"/> meters |

## SECTION D – SURVEYOR, ENGINEER, OR ARCHITECT CERTIFICATION

This certification is to be signed and sealed by a land surveyor, engineer, or architect authorized by law to certify elevation information. I certify that the information on this Certificate represents my best efforts to interpret the data available. I understand that any false statement may be punishable by fine or imprisonment under 18 U.S. Code, Section 1001.

Were latitude and longitude in Section A provided by a licensed land surveyor?  Yes  No  Check here if attachments.

Certifier's Name  
KENNETH L. FRAZIER

License Number  
PLS 16908

Title  
PROFESSIONAL LAND SURVEYOR

Company Name  
FORESIGHT SURVEYING, INC

Address  
1583 N NATIONAL AVE

City  
CHEHALIS

State  
Washington

ZIP Code  
98532

Signature  
*Kenneth L. Frazier*

Date  
01/30/2017

Telephone  
(360) 748-4000

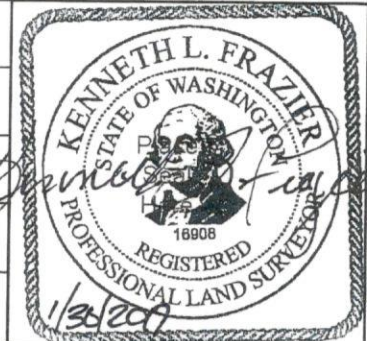

Copy all pages of this Elevation Certificate and all attachments for (1) community official, (2) insurance agent/company, and (3) building owner.

Comments (including type of equipment and location, per C2(e), if applicable)  
THE STRUCTURE IS A FAST FOOD RESTAURANT WITH SLAB ON GRADE. THE SLAB IS AT OR ABOVE THE OUTSIDE GRADE ON ALL SIDES. T  
THE CONSTRUCTION PLANS WERE COMPLETED ON THE NAVD VERTICAL DATAM (180.1 FEET) THE NGVD DATUM IS AT 177.69 FEET AS NOTED IN SECTION C2a.



# ELEVATION CERTIFICATE

OMB No. 1660-0008  
Expiration Date: November 30, 2018

|  |                     |                   |                                  |
|--|---------------------|-------------------|----------------------------------|
| <b>IMPORTANT: In these spaces, copy the corresponding information from Section A.</b>                                      |                     |                   | <b>FOR INSURANCE COMPANY USE</b> |
| Building Street Address (including Apt., Unit, Suite, and/or Bldg. No.) or P.O. Route and Box No.<br>1755 NW LOUISANA AVE. |                     |                   | Policy Number:                   |
| City<br>CHEHALIS   | State<br>Washington | ZIP Code<br>98532 | Company NAIC Number              |

## SECTION E – BUILDING ELEVATION INFORMATION (SURVEY NOT REQUIRED) FOR ZONE AO AND ZONE A (WITHOUT BFE)

For Zones AO and A (without BFE), complete Items E1–E5. If the Certificate is intended to support a LOMA or LOMR-F request, complete Sections A, B, and C. For Items E1–E4, use natural grade, if available. Check the measurement used. In Puerto Rico only, enter meters.

- E1. Provide elevation information for the following and check the appropriate boxes to show whether the elevation is above or below the highest adjacent grade (HAG) and the lowest adjacent grade (LAG).
- a) Top of bottom floor (including basement, crawlspace, or enclosure) is \_\_\_\_\_ . \_\_\_\_\_  feet  meters  above or  below the HAG.
- b) Top of bottom floor (including basement, crawlspace, or enclosure) is \_\_\_\_\_ . \_\_\_\_\_  feet  meters  above or  below the LAG.
- E2. For Building Diagrams 6–9 with permanent flood openings provided in Section A Items 8 and/or 9 (see pages 1–2 of Instructions), the next higher floor (elevation C2.b in the diagrams) of the building is \_\_\_\_\_ . \_\_\_\_\_  feet  meters  above or  below the HAG.
- E3. Attached garage (top of slab) is \_\_\_\_\_ . \_\_\_\_\_  feet  meters  above or  below the HAG.
- E4. Top of platform of machinery and/or equipment servicing the building is \_\_\_\_\_ . \_\_\_\_\_  feet  meters  above or  below the HAG.
- E5. Zone AO only: If no flood depth number is available, is the top of the bottom floor elevated in accordance with the community's floodplain management ordinance?  Yes  No  Unknown. The local official must certify this information in Section G.

## SECTION F – PROPERTY OWNER (OR OWNER'S REPRESENTATIVE) CERTIFICATION

The property owner or owner's authorized representative who completes Sections A, B, and E for Zone A (without a FEMA-issued or community-issued BFE) or Zone AO must sign here. The statements in Sections A, B, and E are correct to the best of my knowledge.

Property Owner or Owner's Authorized Representative's Name

Address \_\_\_\_\_ City \_\_\_\_\_ State \_\_\_\_\_ ZIP Code \_\_\_\_\_

Signature \_\_\_\_\_ Date \_\_\_\_\_ Telephone \_\_\_\_\_

Comments

Check here if attachments.





# BUILDING PHOTOGRAPHS

## ELEVATION CERTIFICATE

See Instructions for Item A6.

OMB No. 1660-0008  
Expiration Date: November 30, 2018

|   |                     |                   |                                  |
|---|---------------------|-------------------|----------------------------------|
| <b>IMPORTANT: In these spaces, copy the corresponding information from Section A.</b>                                       |                     |                   | <b>FOR INSURANCE COMPANY USE</b> |
| Building Street Address (including Apt., Unit, Suite, and/or Bldg. No.) or P.O. Route and Box No.<br>1755 NW LOUISIANA AVE. |                     |                   | Policy Number:                   |
| City<br>CHEHALIS  | State<br>Washington | ZIP Code<br>98532 | Company NAIC Number              |

If using the Elevation Certificate to obtain NFIP flood insurance, affix at least 2 building photographs below according to the instructions for Item A6. Identify all photographs with date taken; "Front View" and "Rear View"; and, if required, "Right Side View" and "Left Side View." When applicable, photographs must show the foundation with representative examples of the flood openings or vents, as indicated in Section A8. If submitting more photographs than will fit on this page, use the Continuation Page.



Photo One

Photo One Caption Front View (north side)



Photo Two

Photo Two Caption Left View (east side)



**ELEVATION CERTIFICATE**

**BUILDING PHOTOGRAPHS**

Continuation Page

OMB No. 1660-0008  
Expiration Date: November 30, 2018

|   |                     |                   |                                  |
|---|---------------------|-------------------|----------------------------------|
| <b>IMPORTANT: In these spaces, copy the corresponding information from Section A.</b>                                       |                     |                   | <b>FOR INSURANCE COMPANY USE</b> |
| Building Street Address (including Apt., Unit, Suite, and/or Bldg. No.) or P.O. Route and Box No.<br>1755 NW LOUISIANA AVE. |                     |                   | Policy Number:                   |
| City<br>CHEHALIS  | State<br>Washington | ZIP Code<br>98532 | Company NAIC Number              |

If submitting more photographs than will fit on the preceding page, affix the additional photographs below. Identify all photographs with: date taken; "Front View" and "Rear View"; and, if required, "Right Side View" and "Left Side View." When applicable, photographs must show the foundation with representative examples of the flood openings or vents, as indicated in Section A8.



Photo One

Photo One Caption Rear View (south side)



Photo Two

Photo Two Caption Right View ( west side )