

# PRELIMINARY

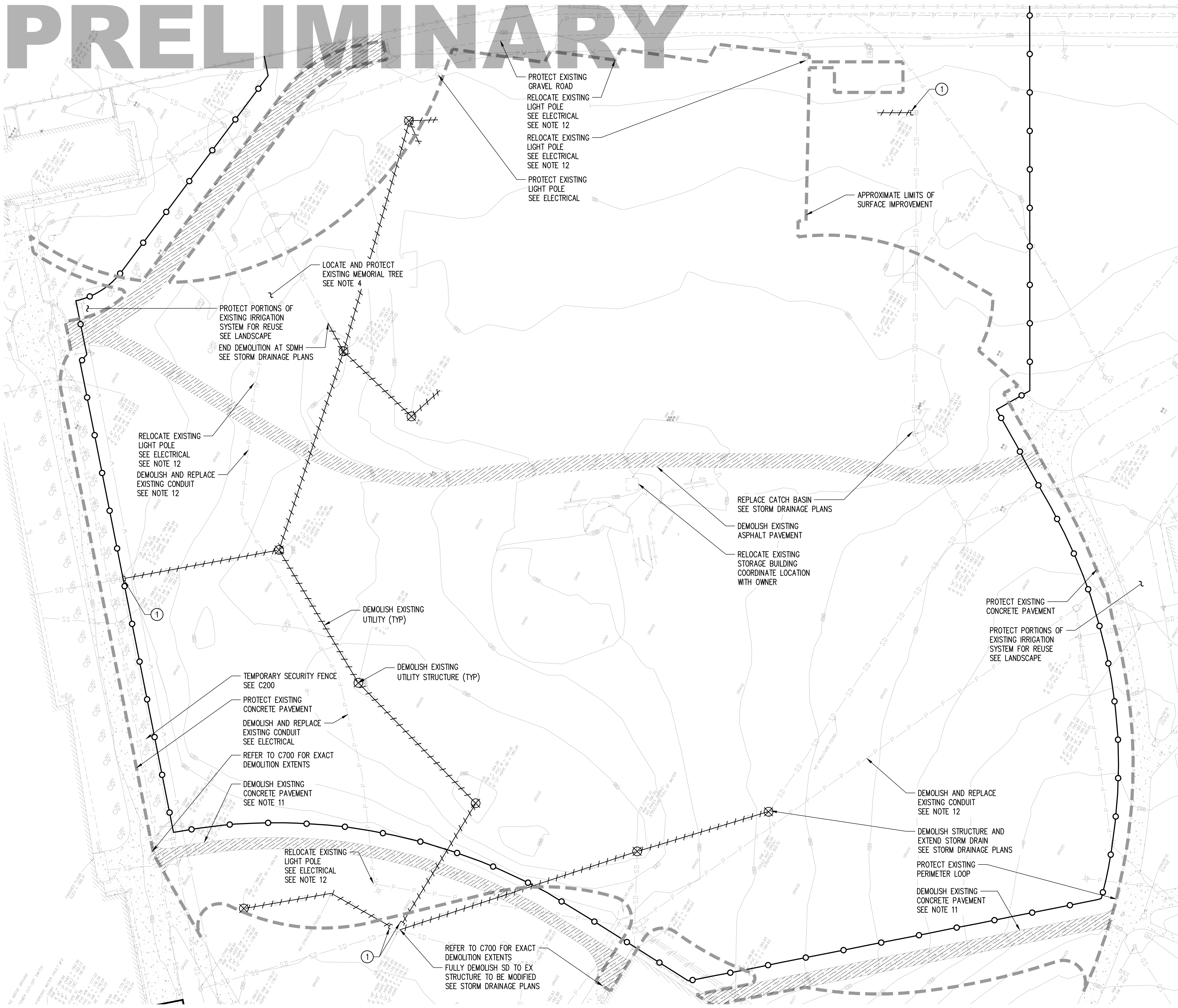

- ### DEMOLITION NOTES
- DEMOLISH ALL SURFACE IMPROVEMENTS WITHIN LIMITS OF SURFACE IMPROVEMENT UNLESS NOTED OTHERWISE.
  - PROTECT ALL UNDERGROUND UTILITIES AND UTILITY STRUCTURES UNLESS NOTED OTHERWISE.
  - UNDERGROUND PIPING AND STRUCTURES TO BE DEMOLISHED SHALL BE REMOVED COMPLETELY FROM THE GROUND AND CAPPED WHERE INDICATED IN PLAN.
  - REFER TO LANDSCAPE FOR TREE PROTECTION MEASURES.
  - ANY FEATURES TO REMAIN THAT ARE DAMAGED DURING DEMOLITION OR CONSTRUCTION ACTIVITIES SHALL BE FULLY REPAIRED AT CONTRACTOR'S EXPENSE AS DIRECTED BY THE OWNER.
  - PRIOR TO DEMOLITION ACTIVITIES, VERIFY THE DEPTH OF EXISTING UTILITIES TO REMAIN WITHIN LIMITS OF SURFACE IMPROVEMENT.
  - PROVIDE CONSTRUCTION FENCING, SIGNAGE, AND BARRIERS AS REQUIRED TO PREVENT UNAUTHORIZED ACCESS TO DEMOLITION AREAS. COORDINATE WITH THE OWNER TO FIELD ADJUST FENCE AS REQUIRED FOR SPECIFIC SITE CONDITIONS.
  - IMMEDIATELY REMOVE ALL DEMOLITION DEBRIS FALLING OUTSIDE THE LIMITS OF SURFACE IMPROVEMENT.
  - DISPOSE OF EXCESS DEMOLITION MATERIAL OFF-SITE IN A SAFE AND LEGAL MANNER.
  - REFER TO SHEET C800 FOR DEMOLITION OF EXISTING RECREATION BUILDING.
  - DEMOLITION OF IMPROVEMENTS FALLING OUTSIDE OF TEMPORARY SECURITY FENCING SHOULD BE COORDINATED WITH THE OWNER, AND WHEREVER POSSIBLE SHALL BE SCHEDULED TO MAINTAIN CONTINUED USE OF EXISTING GHS FACILITIES THROUGHOUT CONSTRUCTION.
  - DEMOLITION AND RELOCATION OF EXISTING LIGHTS, SECURITY CAMERAS, AND ELECTRICAL SYSTEMS SHALL BE COORDINATED WITH THE OWNER TO PROVIDE CONTINUOUS SECURE CONDITION FOR THE DURATION OF CONSTRUCTION.
  - WHERE DEMOLITION, CLEARING, GRUBBING, OR SITE DISTURBANCE OCCURS OUTSIDE OF THE LIMITS OF PROPOSED SURFACE IMPROVEMENTS, THE DISTURBED LAWN AREA SHALL BE RESTORED PER THE APPROPRIATE LANDSCAPE PLANTING DETAILS.

- ### FLAG NOTES
- CUT AND CAP STORM DRAIN AT EXISTING STRUCTURE TO REMAIN

### LEGEND

	LIMIT OF SURFACE IMPROVEMENT
	DEMOLISH EXISTING UTILITY
	TEMPORARY SECURITY FENCE
	CAP UTILITY
	DEMOLISH EXISTING UTILITY STRUCTURE
	DEMOLISH EXISTING PAVEMENT

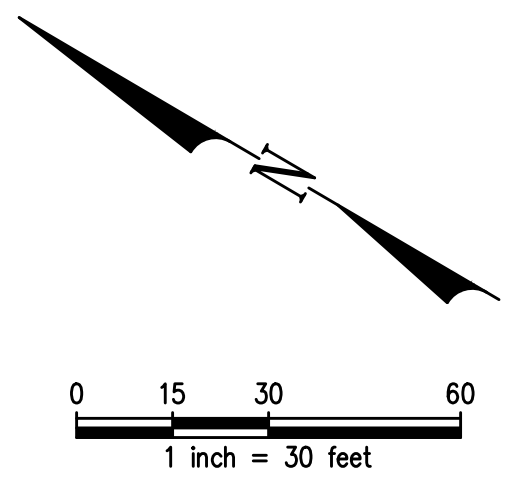

1601 5th Avenue, Suite 1600  
Seattle, WA 98101  
206.622.5822  
www.kpff.com



GREEN HILL SCHOOL RECREATION BUILDING

375 SW 11TH STREET  
CHEHALIS, WA 98532

90% CONSTRUCTION DOCUMENTS  
March 12, 2021  
Revisions

73-18130-00  
DEMOLITION PLAN

C300

Mar 11, 2021 - 4:53pm  
 BrufA  
 \\netf.com\Civil\1800001-1800999\1800416 GIS Recreation Building Replacement\CADD\Design\03 - CD\C300 DEMO.dwg



# PRELIMINARY

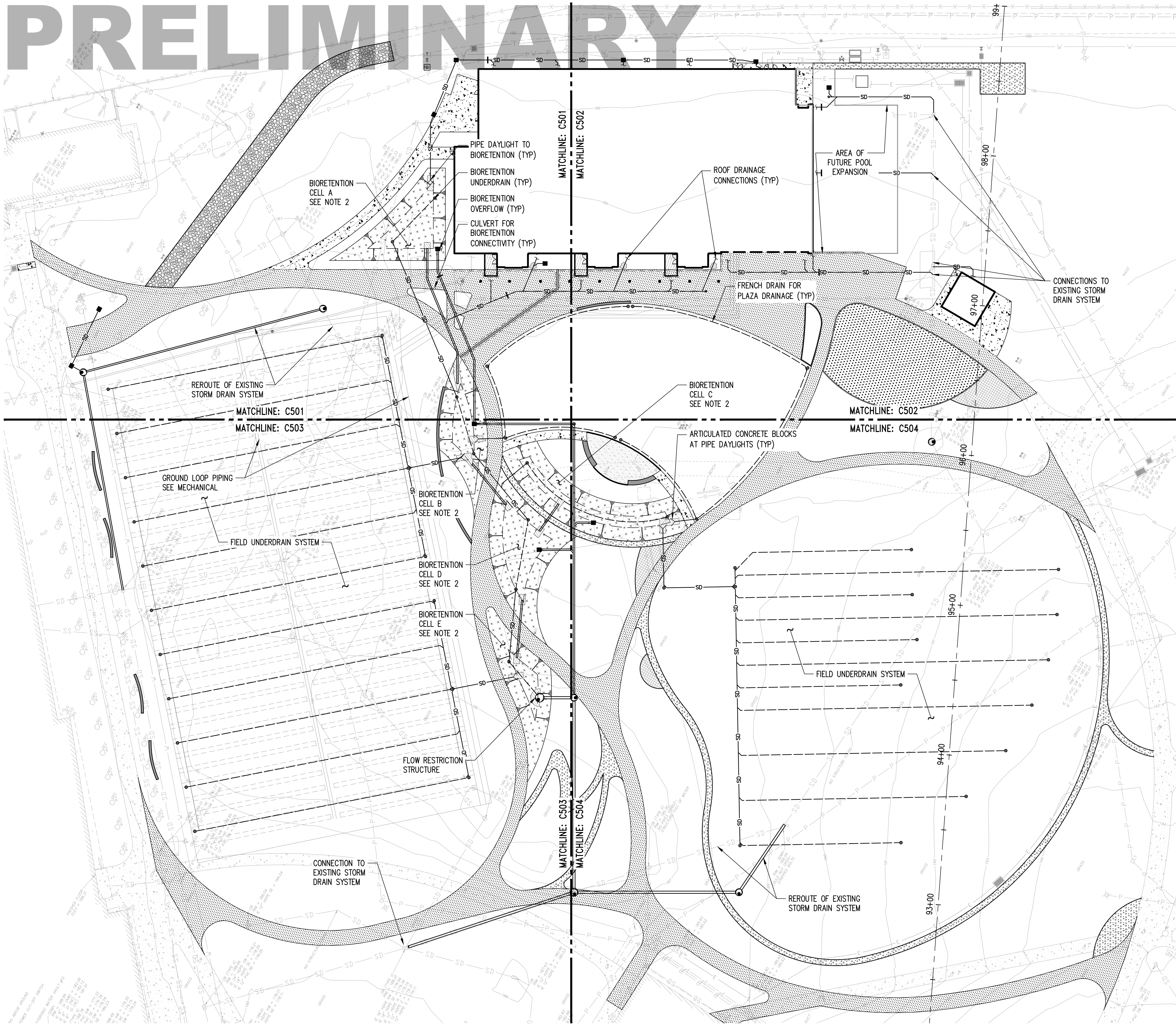

## NOTES

- SEE C501-504 FOR STORM DRAINAGE DESIGN
- REFER TO BIORETENTION CELL SUMMARY TABLE ON C520 FOR PONDING DEPTH, SIDE SLOPES, MINIMUM BOTTOM AREA AND PONDING AREA.

## LEGEND

	STORM DRAIN LESS THAN 12"
	STORM DRAIN 12" AND LARGER
	PERFORATED STORM DRAIN
	STORM DRAIN CATCH BASIN
	STORM DRAIN CLEANOUT
	STORM DRAIN MANHOLE
	PIPE DAYLIGHT
	ARTICULATED CONCRETE BLOCK
	BIORETENTION PLANTER
	VEHICULAR CONCRETE PAVEMENT
	PEDESTRIAN CONCRETE PAVEMENT
	GRAVEL PAVEMENT
	ASPHALT PAVEMENT

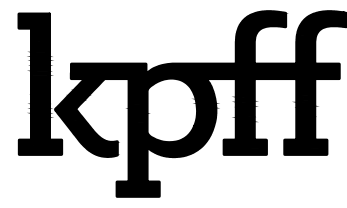
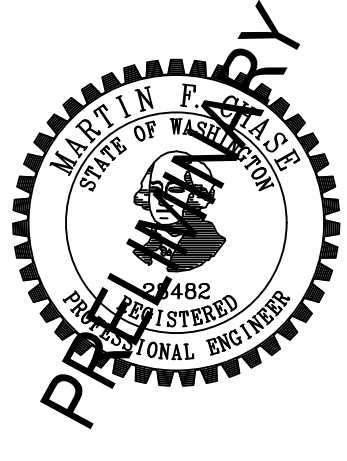

1601 5th Avenue, Suite 1600  
Seattle, WA 98101  
206.622.5822  
www.kpff.com



**GREEN HILL SCHOOL RECREATION BUILDING**  
375 SW 11TH STREET  
CHEHALIS, WA 98532

90% CONSTRUCTION DOCUMENTS  
March 12, 2021  
Revisions

73-18130-00  
**STORM DRAIN PLAN - OVERALL**

**C500**

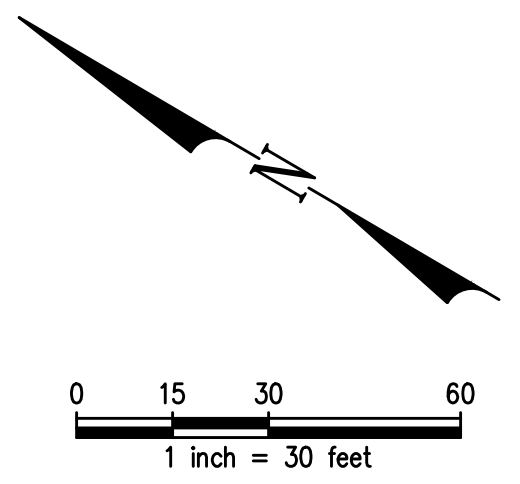

Mar 11, 2021 - 4:54pm  
 \\p\p\com\Civil\180001-180099\1800416 GIS Recreation Building Replacement\CADD\Design\03 - CD\C500 STRU.dwg  
 Broy/R  
 No block shading  
 Layer: 0,1,2,3,4,5,6,7,8,9,10,11,12,13,14,15,16,17,18,19,20,21,22,23,24,25,26,27,28,29,30,31,32,33,34,35,36,37,38,39,40,41,42,43,44,45,46,47,48,49,50,51,52,53,54,55,56,57,58,59,60,61,62,63,64,65,66,67,68,69,70,71,72,73,74,75,76,77,78,79,80,81,82,83,84,85,86,87,88,89,90,91,92,93,94,95,96,97,98,99,100,101,102,103,104,105,106,107,108,109,110,111,112,113,114,115,116,117,118,119,120,121,122,123,124,125,126,127,128,129,130,131,132,133,134,135,136,137,138,139,140,141,142,143,144,145,146,147,148,149,150,151,152,153,154,155,156,157,158,159,160,161,162,163,164,165,166,167,168,169,170,171,172,173,174,175,176,177,178,179,180,181,182,183,184,185,186,187,188,189,190,191,192,193,194,195,196,197,198,199,200,201,202,203,204,205,206,207,208,209,210,211,212,213,214,215,216,217,218,219,220,221,222,223,224,225,226,227,228,229,230,231,232,233,234,235,236,237,238,239,240,241,242,243,244,245,246,247,248,249,250,251,252,253,254,255,256,257,258,259,260,261,262,263,264,265,266,267,268,269,270,271,272,273,274,275,276,277,278,279,280,281,282,283,284,285,286,287,288,289,290,291,292,293,294,295,296,297,298,299,300,301,302,303,304,305,306,307,308,309,310,311,312,313,314,315,316,317,318,319,320,321,322,323,324,325,326,327,328,329,330,331,332,333,334,335,336,337,338,339,340,341,342,343,344,345,346,347,348,349,350,351,352,353,354,355,356,357,358,359,360,361,362,363,364,365,366,367,368,369,370,371,372,373,374,375,376,377,378,379,380,381,382,383,384,385,386,387,388,389,390,391,392,393,394,395,396,397,398,399,400,401,402,403,404,405,406,407,408,409,410,411,412,413,414,415,416,417,418,419,420,421,422,423,424,425,426,427,428,429,430,431,432,433,434,435,436,437,438,439,440,441,442,443,444,445,446,447,448,449,450,451,452,453,454,455,456,457,458,459,460,461,462,463,464,465,466,467,468,469,470,471,472,473,474,475,476,477,478,479,480,481,482,483,484,485,486,487,488,489,490,491,492,493,494,495,496,497,498,499,500,501,502,503,504,505,506,507,508,509,510,511,512,513,514,515,516,517,518,519,520,521,522,523,524,525,526,527,528,529,530,531,532,533,534,535,536,537,538,539,540,541,542,543,544,545,546,547,548,549,550,551,552,553,554,555,556,557,558,559,560,561,562,563,564,565,566,567,568,569,570,571,572,573,574,575,576,577,578,579,580,581,582,583,584,585,586,587,588,589,590,591,592,593,594,595,596,597,598,599,600,601,602,603,604,605,606,607,608,609,610,611,612,613,614,615,616,617,618,619,620,621,622,623,624,625,626,627,628,629,630,631,632,633,634,635,636,637,638,639,640,641,642,643,644,645,646,647,648,649,650,651,652,653,654,655,656,657,658,659,660,661,662,663,664,665,666,667,668,669,670,671,672,673,674,675,676,677,678,679,680,681,682,683,684,685,686,687,688,689,690,691,692,693,694,695,696,697,698,699,700,701,702,703,704,705,706,707,708,709,710,711,712,713,714,715,716,717,718,719,720,721,722,723,724,725,726,727,728,729,730,731,732,733,734,735,736,737,738,739,740,741,742,743,744,745,746,747,748,749,750,751,752,753,754,755,756,757,758,759,760,761,762,763,764,765,766,767,768,769,770,771,772,773,774,775,776,777,778,779,780,781,782,783,784,785,786,787,788,789,790,791,792,793,794,795,796,797,798,799,800,801,802,803,804,805,806,807,808,809,810,811,812,813,814,815,816,817,818,819,820,821,822,823,824,825,826,827,828,829,830,831,832,833,834,835,836,837,838,839,840,841,842,843,844,845,846,847,848,849,850,851,852,853,854,855,856,857,858,859,860,861,862,863,864,865,866,867,868,869,870,871,872,873,874,875,876,877,878,879,880,881,882,883,884,885,886,887,888,889,890,891,892,893,894,895,896,897,898,899,900,901,902,903,904,905,906,907,908,909,910,911,912,913,914,915,916,917,918,919,920,921,922,923,924,925,926,927,928,929,930,931,932,933,934,935,936,937,938,939,940,941,942,943,944,945,946,947,948,949,950,951,952,953,954,955,956,957,958,959,960,961,962,963,964,965,966,967,968,969,970,971,972,973,974,975,976,977,978,979,980,981,982,983,984,985,986,987,988,989,990,991,992,993,994,995,996,997,998,999,1000

# PRELIMINARY

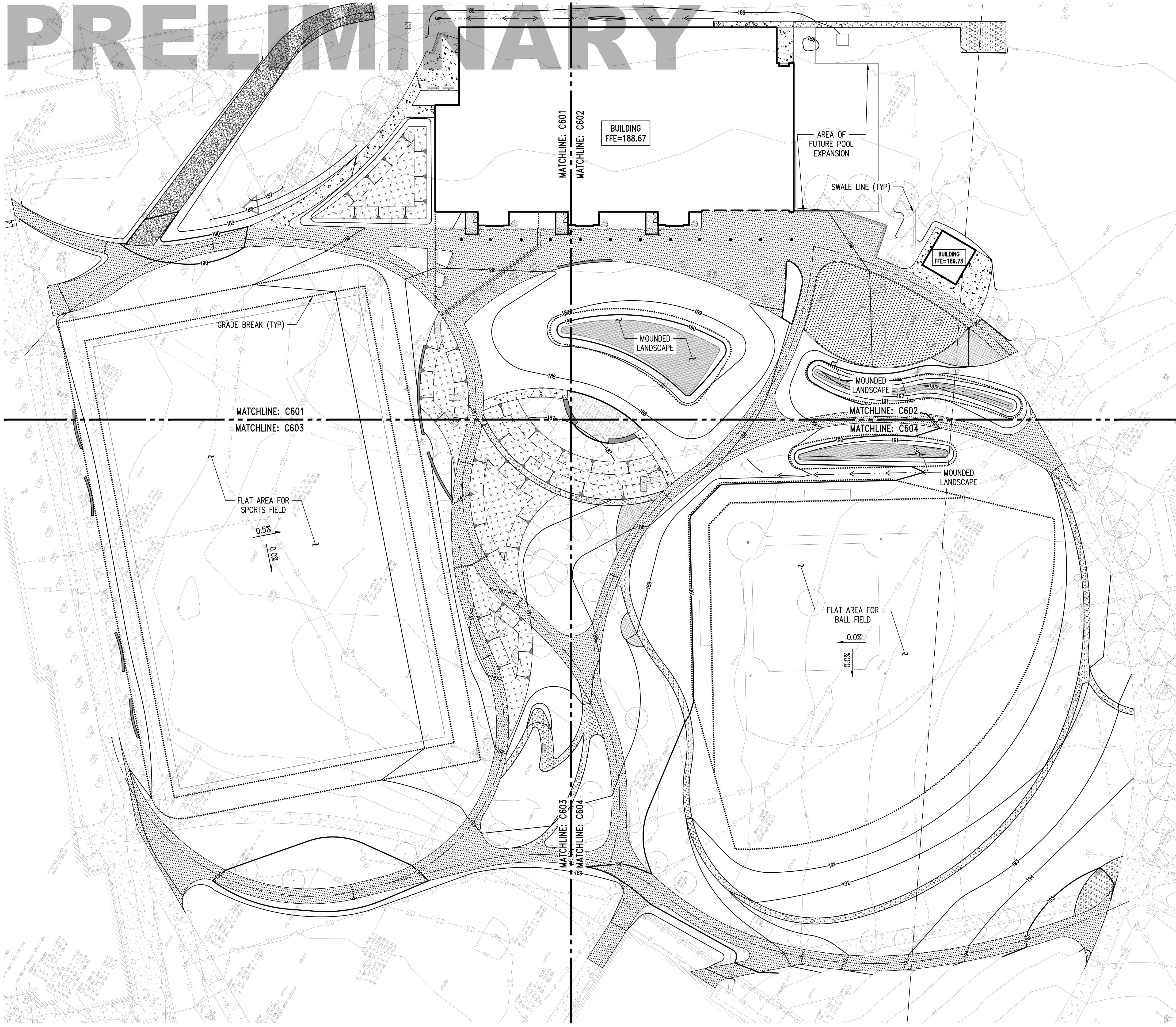

**NOTES**

- SEE C601-604 FOR GRADING DESIGN

**LEGEND**

	BUILDING LINE
	MAJOR CONTOUR
	MINOR CONTOUR
	GRADE BREAK
	SPOT ELEVATION
	APPROXIMATE SURFACE SLOPE
	BIORETENTION SIDE SLOPE
	TOP OF LANDSCAPE MOUND

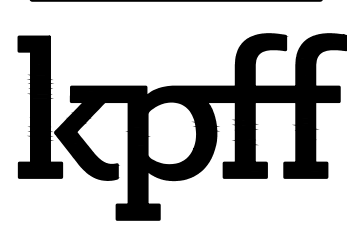

1601 5th Avenue, Suite 1600  
Seattle, WA 98101  
206.622.5822  
www.kpff.com



**GREEN HILL SCHOOL RECREATION BUILDING**

375 SW 11TH STREET  
CHEHALIS, WA 98532

90% CONSTRUCTION DOCUMENTS  
March 12, 2021  
Revisions

73-18130-00  
GRADING PLAN - OVERALL

**C600**

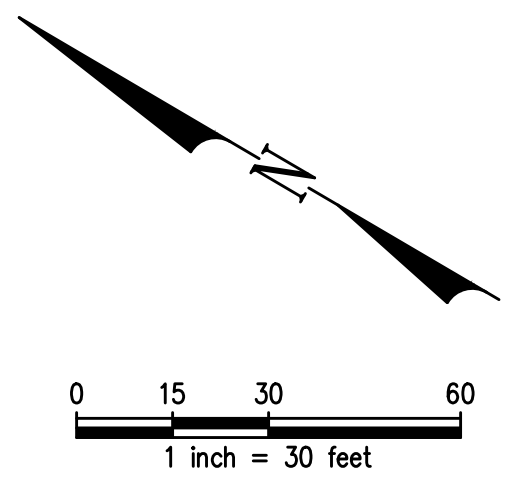

**811** Call 811  
two business days  
before you dig

Mar 11, 2021 - 4:55pm  
 \\pff.com\Civil\180001-180099\1800416 GIS Recreation Building Replacement\CADD\Design\03 - CD\C600 GRAD.dwg  
 BroyR

# PRELIMINARY

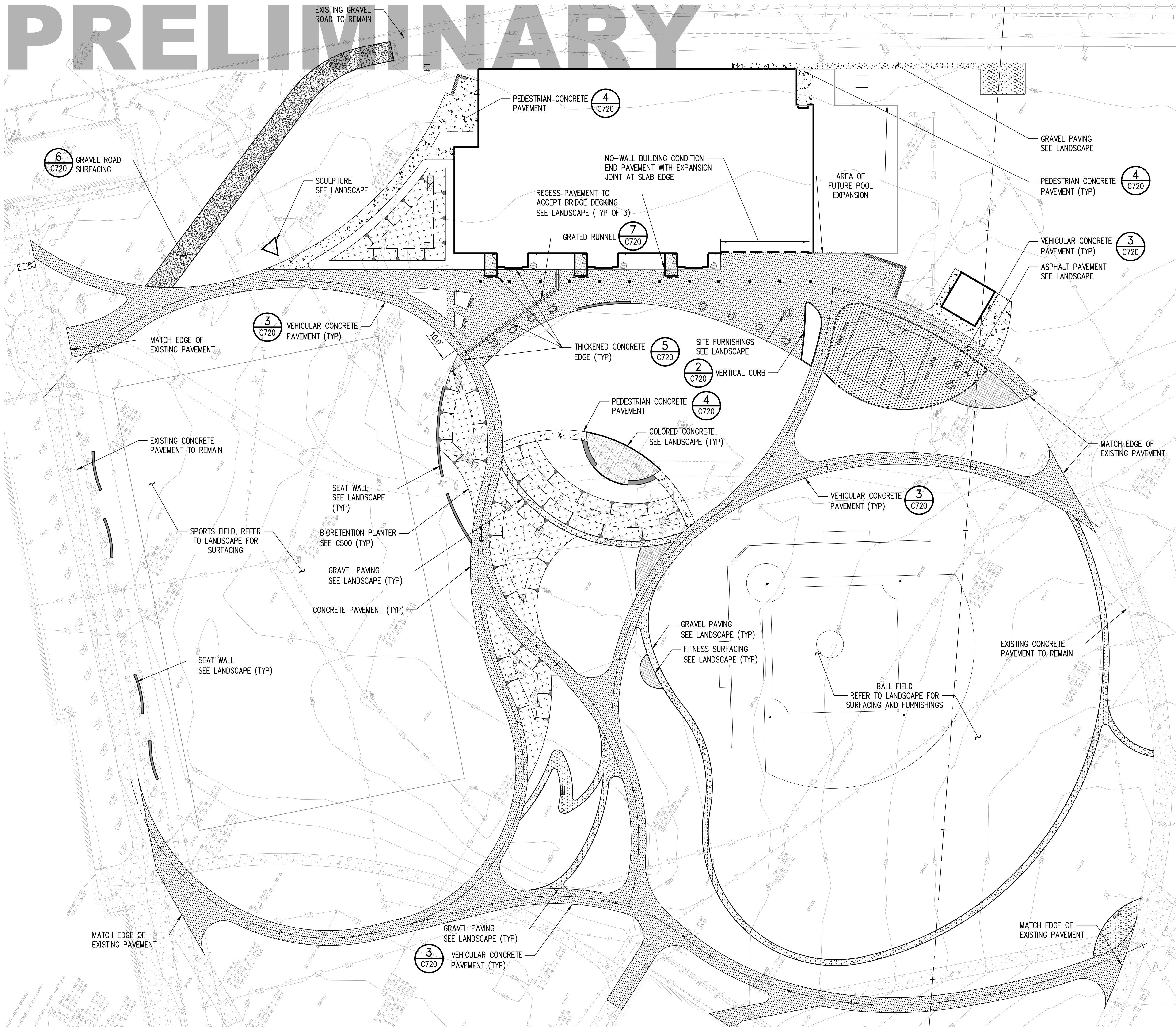

- NOTES**
- REFER TO C100 ANC C150 FOR HORIZONTAL CONTROL OF PAVEMENTS.
  - REFER TO LANDSCAPE FOR DETAILS AND HORIZONTAL CONTROL OF PEDESTRIAN PAVEMENTS.
  - REFER TO LANDSCAPE FOR PLANTING DESIGN OF UNPAVED AREAS.

**LEGEND**

	FLUSH CURB
	VERTICAL CURB
	CENTERLINE ALIGNMENT
	VEHICULAR CONCRETE PAVEMENT
	PEDESTRIAN CONCRETE PAVEMENT
	GRAVEL PAVING (SEE LANDSCAPE)
	ASPHALT PAVING (SEE LANDSCAPE)
	BIORETENTION PLANTER (SEE C500)
	GRAVEL ROAD SURFACING
	FITNESS AREA SURFACING (SEE LANDSCAPE)

**DLR Group**  
 1601 5th Avenue, Suite 1600  
 Seattle, WA 98101  
 206.622.5822  
 www.kpff.com

**kpff**  
 1601 5th Avenue, Suite 1600  
 Seattle, WA 98101  
 206.622.5822  
 www.kpff.com

Washington State Department of  
**CHILDREN, YOUTH & FAMILIES**

**GREEN HILL SCHOOL RECREATION BUILDING**  
 376 SW 11TH STREET  
 CHEHALIS, WA 98532

90% CONSTRUCTION DOCUMENTS  
 March 12, 2021  
 Revisions

73-18130-00  
**PAVING PLAN**

**C700**

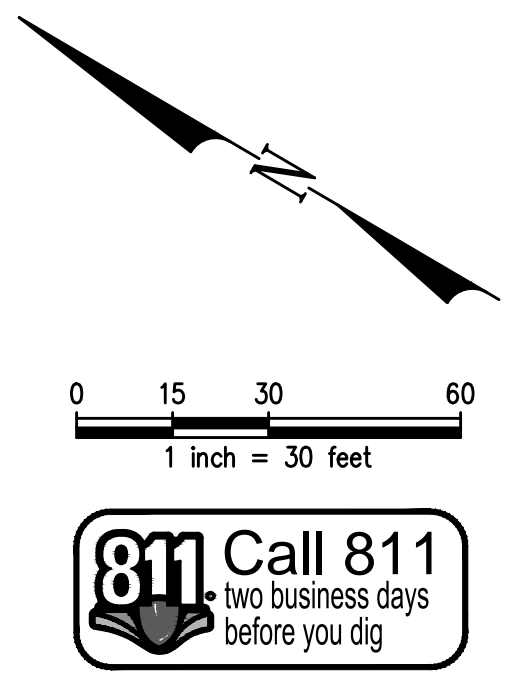

Mar 11, 2021 - 4:56pm  
 \\veff.com\Civil\180001-180099\1800416 GIS Recreation Building Replacement\CADD\Design\03 - CD\C700 PAVE.dwg  
 Broy/R

# PRELIMINARY

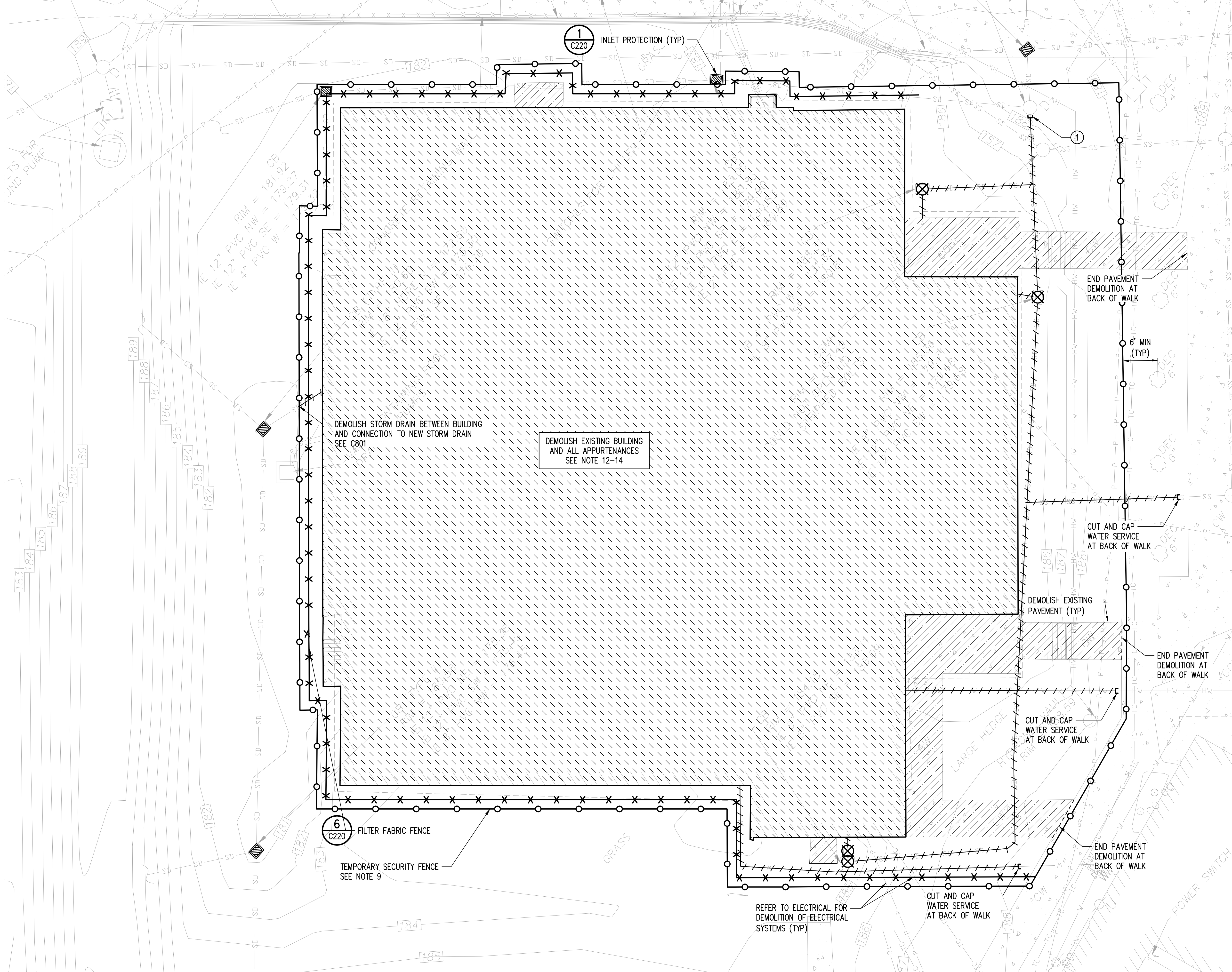

- ### DEMOLITION NOTES
- REFER TO SHEET C200 FOR TEMPORARY EROSION CONTROL AND CONSTRUCTION STORMWATER POLLUTION PREVENTION NOTES.
  - ALL SURFACE FEATURES AND IMPROVEMENTS ARE INTENDED TO REMAIN UNLESS NOTED OTHERWISE.
  - PROTECT ALL UNDERGROUND UTILITIES AND UTILITY STRUCTURES UNLESS NOTED OTHERWISE.
  - UNDERGROUND PIPING AND STRUCTURES TO BE DEMOLISHED SHALL BE REMOVED COMPLETELY FROM THE GROUND AND CAPPED WHERE INDICATED IN PLAN.
  - REFER TO LANDSCAPE FOR TREE PROTECTION.
  - REFER TO ELECTRICAL FOR DEMOLITION OF EXISTING ELECTRICAL SYSTEMS.
  - ANY FEATURES TO REMAIN THAT ARE DAMAGED DURING DEMOLITION OR CONSTRUCTION ACTIVITIES SHALL BE FULLY REPAIRED AT CONTRACTOR'S EXPENSE AS DIRECTED BY THE OWNER.
  - PRIOR TO DEMOLITION ACTIVITIES, VERIFY THE DEPTH OF EXISTING UTILITIES TO REMAIN WITHIN THE LIMIT OF WORK.
  - PROVIDE TEMPORARY SECURITY CONSTRUCTION FENCING, SIGNAGE, AND BARRIERS AS REQUIRED TO PREVENT UNAUTHORIZED ACCESS TO DEMOLITION AREAS. COORDINATE WITH THE OWNER TO FIELD ADJUST FENCE AS REQUIRED FOR SPECIFIC SITE CONDITIONS. SEE C200 NOTES 2-4 FOR ADDITIONAL REQUIREMENTS.
  - IMMEDIATELY REMOVE ALL DEMOLITION DEBRIS FALLING OUTSIDE THE LIMITS OF WORK.
  - DISPOSE OF EXCESS DEMOLITION MATERIAL OFF-SITE IN A SAFE AND LEGAL MANNER.
  - BUILDING DEMOLITION SHALL NOT OCCUR UNTIL CONSTRUCTION OF THE NEW RECREATION BUILDING IS COMPLETE.
  - REFER TO ARCHITECTURAL FOR MATERIALS TO BE SALVAGED FROM EXISTING BUILDING.
  - HAZARDOUS MATERIAL ABATEMENT BY OTHERS, IF REQUIRED FOR BUILDING DEMOLITION.
  - CONSTRUCTION ACCESS TO EXISTING RECREATION BUILDING SHALL BE VIA EXISTING VEHICLE SALLY PORT AND NORTHWESTERN PERIMETER ACCESS ROAD.

- ### FLAG NOTES
- CUT AND CAP STORM DRAIN AT EXISTING STRUCTURE TO REMAIN

### LEGEND

	DEMOLISH EXISTING UTILITY
	SAWCUT LINE
	TEMPORARY SECURITY FENCE
	FILTER FABRIC FENCE
	INLET PROTECTION
	CAP UTILITY
	DEMOLISH EXISTING UTILITY STRUCTURE
	DEMOLISH EXISTING BUILDING
	DEMOLISH EXISTING PAVEMENT

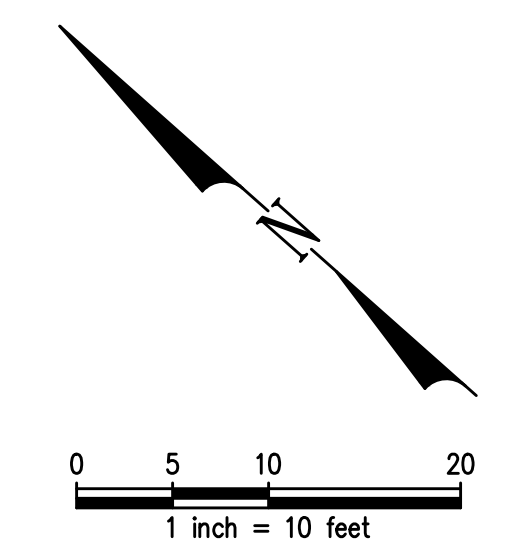

**811 Call 811**  
two business days  
before you dig

**DLR Group**  
© DLR Group

**PROFESSIONAL ENGINEER**  
MARTIN P. JENSEN  
LICENSE NO. 482  
WASHINGTON STATE  
PROFESSIONAL ENGINEERS

**kpff**  
1601 5th Avenue, Suite 1600  
Seattle, WA 98101  
206.622.5822  
www.kpff.com

Washington State Department of  
**CHILDREN, YOUTH & FAMILIES**

**GREEN HILL SCHOOL RECREATION BUILDING**  
375 SW 11TH STREET  
CHEHALIS, WA 98532

90% CONSTRUCTION DOCUMENTS  
March 12, 2021  
Revisions

73-18130-00

EXISTING REC BUILDING DEMOLITION PLAN

**C800**

Mar 11, 2021 - 4:57pm  
BroydR  
\\netf.com\Civil\1800001-1800999\1800416 GIS Recreation Building Replacement\CADD\Design\03 - CD\C800 EXST DEMO.dwg

# PRELIMINARY

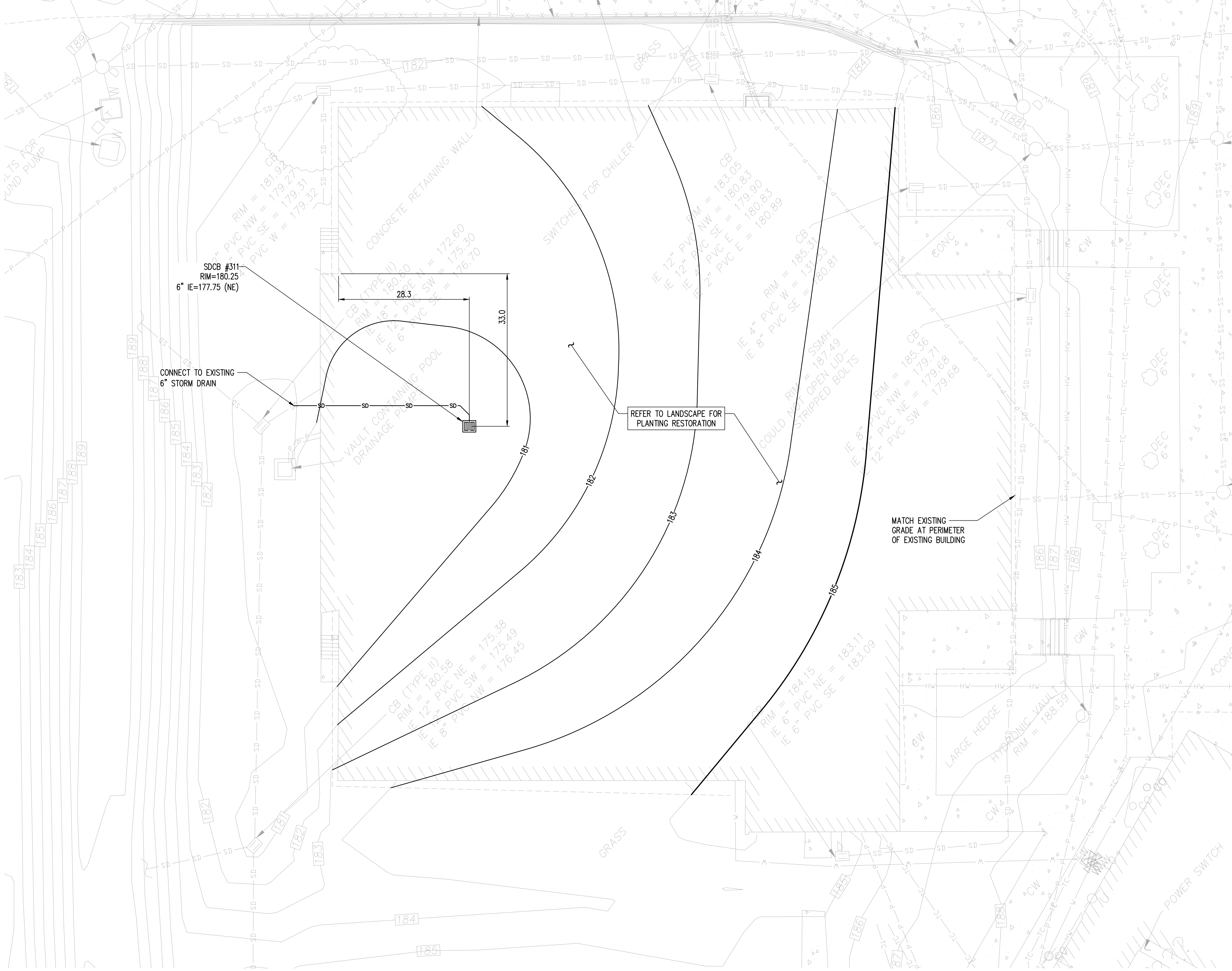

### NOTES

- REFER TO LANDSCAPE FOR PLANTING RESTORATION
- STORM DRAIN CATCH BASIN SHALL BE PER COC STD DWG 3-1.

### LEGEND

- XXX— MAJOR CONTOUR
- - - - - MINOR CONTOUR
- SD— STORM DRAIN
- STORM DRAIN CATCH BASIN

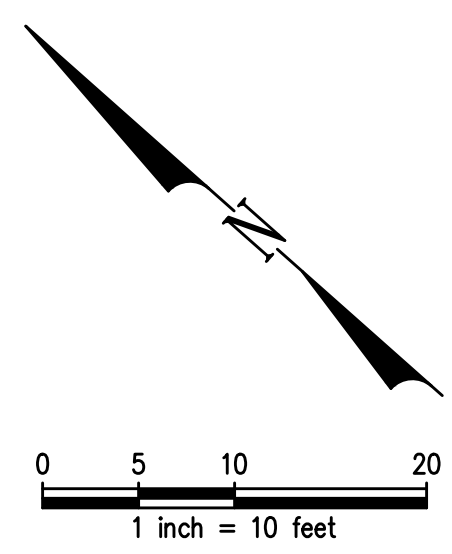

Mar 11, 2021 - 4:57pm  
 BrndR  
 \\veff.com\Civil\180001-180099\1800416 GIS Recreation Building Replacement\CAD\Design\03 - CD\C801 EXST RSTR.dwg

**DLR Group**  
 © DLR Group

**PROFESSIONAL ENGINEER**  
 MARTIN F. ANDERSON  
 LICENSE NO. 482  
 WASHINGTON STATE BOARD OF PROFESSIONAL ENGINEERS

**kpff**  
 1601 5th Avenue, Suite 1600  
 Seattle, WA 98101  
 206.622.5822  
 www.kpff.com

Washington State Department of  
**CHILDREN, YOUTH & FAMILIES**

**GREEN HILL SCHOOL RECREATION BUILDING**  
 376 SW 11TH STREET  
 CHEHALIS, WA 98532

90% CONSTRUCTION DOCUMENTS  
 March 12, 2021  
 Revisions

73-18130-00  
 EXISTING REC BUILDING RESTORATION PLAN  
**C801**