



Building and Planning Department
1321 S. Market Blvd., Chehalis, WA 98532
360. 345.2229/Fax: 360.345.1039
www.ci.chehalis.wa.us email: comdev@ci.chehalis.wa.us

March 31, 2022

Dear Property Owner,

Fuller Designs is proposing a multifamily housing project with 4 two-story fourplexes, and 4 two-story duplexes in an R1 zone. They have applied for a rezone. By law, the City is required to send notice to all property owners within 300 feet of this area. This may be the only opportunity you have to comment. If you have any questions or comments, please follow the directions below in the Notice of Application.

NOTICE OF PUBLIC HEARING

Request: Conditional Use Permit

Applicant: Fuller Designs, 1101 Kresky Ave, Centralia WA 98531
Land Use Case#: CU-21-002

Date of Application: June 24, 2021

Date of Complete Application: March 7, 2022

Project Location: 1137 SE Washington Ave; Lewis County Parcel 005853001000, 00549000000, 005490001000, 005492002000, 005604192001

Proposal: Fuller Designs is proposing a multifamily housing project with 4 two-story fourplexes, and 4 two-story duplexes in an R1 zone. They have applied for a rezone.

Hearing Date and Location: April 14, 2022. 4:00PM. Chehalis City Hall Council Chambers:
350 N. Market Blvd, Chehalis WA 98532350 N. Market Blvd, Chehalis WA 98532

City Contact: To view the complete application online:
<https://www.ci.chehalis.wa.us/building/public-notices-development-review-committee-drc>
To contact Amelia Schwartz, City Planner:
Phone: 360.485.0373 (8am-4:30pm)
Email: aschwartz@ci.chehalis.wa.us
Building and Planning Department
1321 S. Market Blvd
Chehalis WA 98532

****WRITTEN PUBLIC COMMENTS CAN BE ACCEPTED UNTIL 3:00 PM ON APRIL 14, 2022****

Anyone interested may appear and be heard. The decision will be sent to all those who submit comments, testify at the hearing, or request the decision in writing. Any aggrieved party of record can file an appeal with Lewis County Superior Court. Written comments must be submitted to Amelia Schwartz at the listed address above. If you have questions, please visit the website or call.

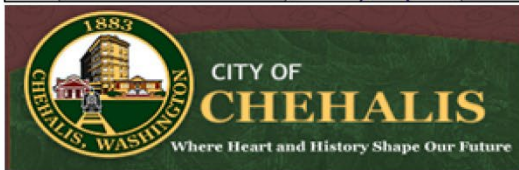
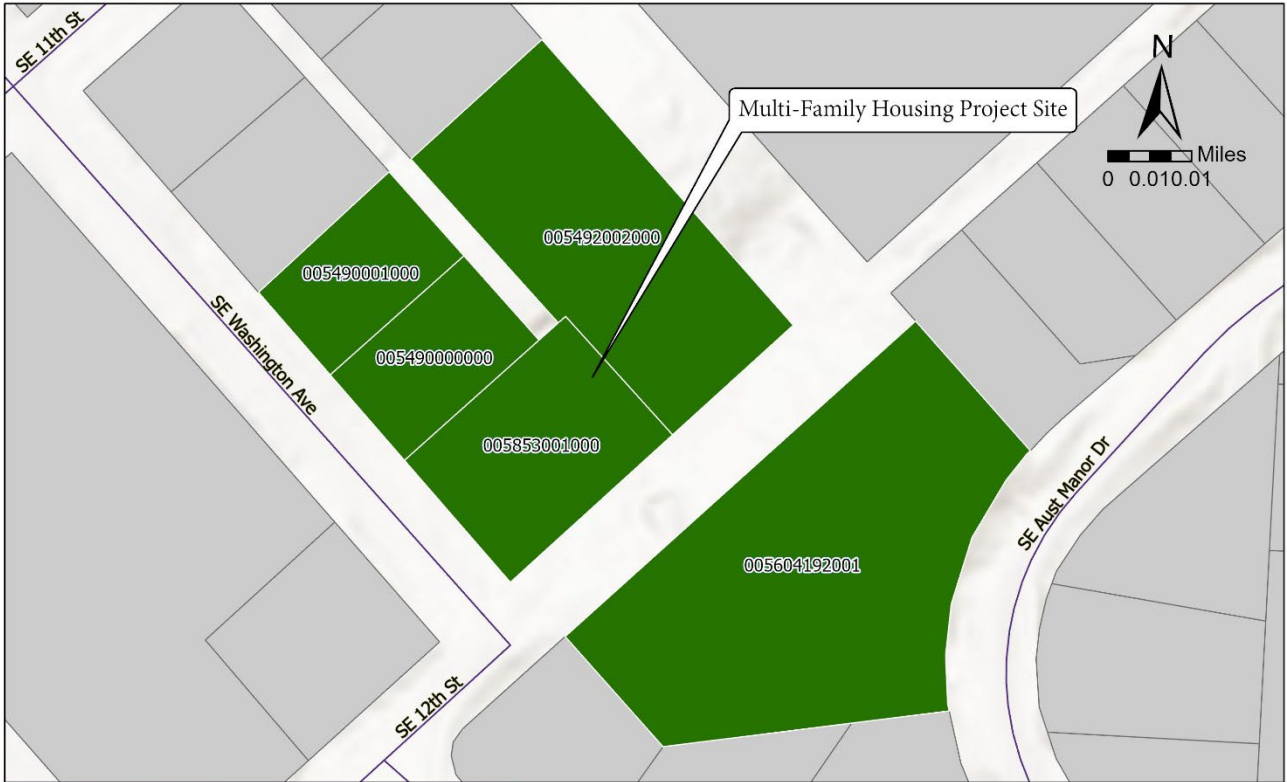

Vicinity Map for CU-21-002