



WASHINGTON STATE

Joint Aquatic Resources Permit Application (JARPA) Form^{1,2} [\[help\]](#)

USE BLACK OR BLUE INK TO ENTER ANSWERS IN THE WHITE SPACES BELOW.



US Army Corps of Engineers
Sea to Sky

AGENCY USE ONLY

Date received: JUN 17 2019 *PK*

Agency reference #: UGA-JARPA-19-0001

Tax Parcel #(s): 017840006000

UGA-SEPA-19-0002

REVISPD UGA-CP-19-001

Part 1—Project Identification

1. Project Name (A name for your project that you create. Examples: Smith's Dock or Seabrook Lane Development) [\[help\]](#)

Jackson Highway Condos

Part 2—Applicant

The person and/or organization responsible for the project. [\[help\]](#)

2a. Name (Last, First, Middle)

Hubbard, Ralph "Kevin"

2b. Organization (If applicable)

2c. Mailing Address (Street or PO Box)

PO Box 1125

2d. City, State, Zip

Chehalis, WA 98532

2e. Phone (1)

(360) 880-7851

2f. Phone (2)

(360) 245-3745

2g. Fax

2h. E-mail

hubbardandsons@gmail.com

¹Additional forms may be required for the following permits:

- If your project may qualify for Department of the Army authorization through a Regional General Permit (RGP), contact the U.S. Army Corps of Engineers for application information (206) 764-3495.
- If your project might affect species listed under the Endangered Species Act, you will need to fill out a Specific Project Information Form (SPIF) or prepare a Biological Evaluation. Forms can be found at <http://www.nws.usace.army.mil/Missions/CivilWorks/Regulatory/PermitGuidebook/EndangeredSpecies.aspx>.
- Not all cities and counties accept the JARPA for their local Shoreline permits. If you need a Shoreline permit, contact the appropriate city or county government to make sure they accept the JARPA.

²To access an online JARPA form with [\[help\]](#) screens, go to

http://www.epermitting.wa.gov/site/alias_resourcecenter/jarpa_jarpa_form/9984/jarpa_form.aspx.

For other help, contact the Governor's Office for Regulatory Innovation and Assistance at (800) 917-0043 or help@oria.wa.gov.

Part 3—Authorized Agent or Contact

Person authorized to represent the applicant about the project. (Note: Authorized agent(s) must sign 11b of this application.) [\[help\]](#)

3a. Name (Last, First, Middle)			
Bartlett, Joanne			
3b. Organization (If applicable)			
Ecological Land Services, Inc.			
3c. Mailing Address (Street or PO Box)			
1157 3 rd Avenue, Suite 220A			
3d. City, State, Zip			
Longview, Washington 98362			
3e. Phone (1)	3f. Phone (2)	3g. Fax	3h. E-mail
(360) 578-1371	(360) 674-7186	(360) 414-9305	joanne@eco-land.com

Part 4—Property Owner(s)

Contact information for people or organizations owning the property where the project will occur. Consider both **upland and aquatic** ownership because the upland owners may not own the adjacent aquatic land. [\[help\]](#)

- Same as applicant. (Skip to Part 5.)
- Repair or maintenance activities on existing rights-of-way or easements. (Skip to Part 5.)
- There are multiple upland property owners. Complete the section below and fill out [JARPA Attachment A](#) for each additional property owner.
- Your project is on Department of Natural Resources (DNR)-managed aquatic lands. If you don't know, contact the DNR at (360) 902-1100 to determine aquatic land ownership. If yes, complete [JARPA Attachment E](#) to apply for the Aquatic Use Authorization.

4a. Name (Last, First, Middle)			
4b. Organization (If applicable)			
4c. Mailing Address (Street or PO Box)			
4d. City, State, Zip			
4e. Phone (1)	4f. Phone (2)	4g. Fax	4h. E-mail

Part 5–Project Location(s)

Identifying information about the property or properties where the project will occur. [\[help\]](#)

- There are multiple project locations (e.g. linear projects). Complete the section below and use [JARPA Attachment B](#) for each additional project location.

5a. Indicate the type of ownership of the property. (Check all that apply.) [help]			
<input checked="" type="checkbox"/> Private <input type="checkbox"/> Federal <input type="checkbox"/> Publicly owned (state, county, city, special districts like schools, ports, etc.) <input type="checkbox"/> Tribal <input type="checkbox"/> Department of Natural Resources (DNR) – managed aquatic lands (Complete JARPA Attachment E)			
5b. Street Address (Cannot be a PO Box. If there is no address, provide other location information in 5p.) [help]			
3040 Jackson Highway			
5c. City, State, Zip (If the project is not in a city or town, provide the name of the nearest city or town.) [help]			
Chehalis, WA 98532			
5d. County [help]			
Lewis County			
5e. Provide the section, township, and range for the project location. [help]			
¼ Section	Section	Township	Range
NW ¼	13	13 N	2 WWM
5f. Provide the latitude and longitude of the project location. [help]			
<ul style="list-style-type: none"> Example: 47.03922 N lat. / -122.89142 W long. (Use decimal degrees - NAD 83) 			
46.613864 N. latitude / -122.885456 W. longitude			
5g. List the tax parcel number(s) for the project location. [help]			
<ul style="list-style-type: none"> The local county assessor's office can provide this information. 			
017840006000			
5h. Contact information for all adjoining property owners. (If you need more space, use JARPA Attachment C.) [help]			
Name	Mailing Address	Tax Parcel # (if known)	
Theonnes, Kelly	11997 Dragon Crest Drive ----- El Paso, TX 79936-0362	017840015004	
Raymor, Willard and Diann	PO Box 261 ----- Onalaska, WA 98570	017840015003	
Hubbard, Kevin & Debbie (same as project owner)	PO Box 1125 ----- Chehalis, WA 98532	017864005003	
Newaukum Valley Golf Course Inc.	153 Newaukum Golf Drive ----- Chehalis, WA 98532	017864005004	

5i. List all wetlands on or adjacent to the project location. [\[help\]](#)

There is an emergent and scrub/shrub wetland offsite to the south and west and 15 small depressional wet areas at the west end of the property.

5j. List all waterbodies (other than wetlands) on or adjacent to the project location. [\[help\]](#)

There is an agricultural ditch along the south edge of the property that separates the offsite wetland from this property.

5k. Is any part of the project area within a 100-year floodplain? [\[help\]](#)

Yes No Don't know

5l. Briefly describe the vegetation and habitat conditions on the property. [\[help\]](#)

The property is current composed of a maintained field that abuts the onsite home to the east and residential development to the north. A scrub/shrub wetland was identified offsite to the south. There are no onsite habitat features.

5m. Describe how the property is currently used. [\[help\]](#)

The property is currently developed with a single family home located along Jackson Highway near the northeastern property line. The remainder of the property is composed of a maintained field that is used for recreational activities including walking dogs and bike riding.

5n. Describe how the adjacent properties are currently used. [\[help\]](#)

The surrounding properties are mostly single-family residences. There are multi-family residential units under the same ownership to the north of this project. The Newaukum Valley Golf Course is located to the southwest and Jackson Highway is located on the northeastern property line.

5o. Describe the structures (above and below ground) on the property, including their purpose(s) and current condition. [\[help\]](#)

There is an occupied single family rental house that is accessed from Jackson Highway near the northeastern property in average condition.

5p. Provide driving directions from the closest highway to the project location, and attach a map. [\[help\]](#)

From Interstate 5 take Exit 74, turn east onto LaBree Road that continues on as Maurin Road, go approximately 1.3 miles and turn left onto Rush Road, go approximately 500 feet and turn left onto Jackson Highway, go approximately 1.5 miles and 3040 Jackson Highway will be on the right.

Part 6–Project Description

6a. Briefly summarize the overall project. You can provide more detail in 6b. [\[help\]](#)

The project proposes the development of an 12-unit residential condominium complex to include associated driveway, parking, stormwater, and water & sewer connection to City of Chehalis on approximately 2 acres of property.

6b. Describe the purpose of the project and why you want or need to perform it. [\[help\]](#)

The purpose of the project is to create housing to meet our county's need with the rise in population.

6c. Indicate the project category. (Check all that apply) [\[help\]](#)

- Commercial Residential Institutional Transportation Recreational
 Maintenance Environmental Enhancement

6d. Indicate the major elements of your project. (Check all that apply) [\[help\]](#)

- | | | | |
|---|---|--|--|
| <input type="checkbox"/> Aquaculture | <input type="checkbox"/> Culvert | <input type="checkbox"/> Float | <input type="checkbox"/> Retaining Wall (upland) |
| <input type="checkbox"/> Bank Stabilization | <input type="checkbox"/> Dam / Weir | <input type="checkbox"/> Floating Home | <input type="checkbox"/> Road |
| <input type="checkbox"/> Boat House | <input type="checkbox"/> Dike / Levee / Jetty | <input type="checkbox"/> Geotechnical Survey | <input type="checkbox"/> Scientific Measurement Device |
| <input type="checkbox"/> Boat Launch | <input type="checkbox"/> Ditch | <input type="checkbox"/> Land Clearing | <input type="checkbox"/> Stairs |
| <input type="checkbox"/> Boat Lift | <input type="checkbox"/> Dock / Pier | <input type="checkbox"/> Marina / Moorage | <input type="checkbox"/> Stormwater facility |
| <input type="checkbox"/> Bridge | <input type="checkbox"/> Dredging | <input type="checkbox"/> Mining | <input type="checkbox"/> Swimming Pool |
| <input type="checkbox"/> Bulkhead | <input type="checkbox"/> Fence | <input type="checkbox"/> Outfall Structure | <input type="checkbox"/> Utility Line |
| <input type="checkbox"/> Buoy | <input type="checkbox"/> Ferry Terminal | <input type="checkbox"/> Piling/Dolphin | |
| <input type="checkbox"/> Channel Modification | <input type="checkbox"/> Fishway | <input type="checkbox"/> Raft | |

Other: Construction of 12-unit condominium complex with associated parking, driveway and utilities.

6e. Describe how you plan to construct each project element checked in 6d. Include specific construction methods and equipment to be used. [\[help\]](#)

- Identify where each element will occur in relation to the nearest waterbody.
- Indicate which activities are within the 100-year floodplain.

Standard construction methods will be utilized for the construction of the condominium project in one phase. Equipment used will include backhoes, forklifts, dump trucks and delivery vehicles. Construction will be limited to daylight hours Monday through Friday. No activities are proposed within the 100-year floodplain.

6f. What are the anticipated start and end dates for project construction? (Month/Year) [\[help\]](#)

- If the project will be constructed in phases or stages, use [JARPA Attachment D](#) to list the start and end dates of each phase or stage.

Start Date: August 2019 End Date: December 2019 See JARPA Attachment D

6g. Fair market value of the project, including materials, labor, machine rentals, etc. [\[help\]](#)

\$1,200,000.00

6h. Will any portion of the project receive federal funding? [\[help\]](#)

- **If yes**, list each agency providing funds.

Yes No Don't know

Part 7–Wetlands: Impacts and Mitigation

Check here if there are wetlands or wetland buffers on or adjacent to the project area.
(If there are none, skip to Part 8.) [\[help\]](#)

7a. Describe how the project has been designed to avoid and minimize adverse impacts to wetlands. [\[help\]](#)

Not applicable

The project has been designed to utilize most of the upland portion of the field to construct the 12-unit condo complex, which is reduced from the original 18-unit complex proposed in 2016. The number of units is at the minimum to be feasible and although it is avoiding most of the onsite wetlands, it requires direct impact to two of the smallest of the wetlands. Wetlands N and O are at the eastern extent of the onsite wetlands and they are 83 square feet and 50 square feet in size, respectively. The project has minimized the impacts by proposing only 133 square feet to accomplish the proposed project. The remainder of the wetlands including the mostly offsite Wetland I will not be directly or indirectly impacted by the proposed project.

7b. Will the project impact wetlands? [\[help\]](#)

Yes No Don't know

7c. Will the project impact wetland buffers? [\[help\]](#)

Yes No Don't know

7d. Has a wetland delineation report been prepared? [\[help\]](#)

- If Yes, submit the report, including data sheets, with the JARPA package.

Yes No

7e. Have the wetlands been rated using the Western Washington or Eastern Washington Wetland Rating System? [\[help\]](#)

- If Yes, submit the wetland rating forms and figures with the JARPA package.

Yes No Don't know

7f. Have you prepared a mitigation plan to compensate for any adverse impacts to wetlands? [\[help\]](#)

- If Yes, submit the plan with the JARPA package and answer 7g.
- If No, or Not applicable, explain below why a mitigation plan should not be required.

Yes No Don't know

7g. Summarize what the mitigation plan is meant to accomplish, and describe how a watershed approach was used to design the plan. [\[help\]](#)

The mitigation plan proposes onsite, permittee-responsible enhancement of 2,032 square feet of emergent wetland for 133 square feet of direct impact to Wetlands N and O. The small size of the wetland impact made onsite enhancement of the remaining wetlands adequate compensation for the proposed impact.

7h. Use the table below to list the type and rating of each wetland impacted, the extent and duration of the impact, and the type and amount of mitigation proposed. Or if you are submitting a mitigation plan with a similar table, you can state (below) where we can find this information in the plan. [\[help\]](#)

Activity (fill, drain, excavate, flood, etc.)	Wetland Name ¹	Wetland type and rating category ²	Impact area (sq. ft. or Acres)	Duration of impact ³	Proposed mitigation type ⁴	Wetland mitigation area (sq. ft. or acres)
Fill	Wetland N	Emergent Category IV	83 sq. ft.	Permanent	Enhancement	2,032 sq. ft.
Fill	Wetland O	Emergent Category IV	50 sq. ft.	Permanent	Enhancement	

¹ If no official name for the wetland exists, create a unique name (such as "Wetland 1"). The name should be consistent with other project documents, such as a wetland delineation report.

² Ecology wetland category based on current Western Washington or Eastern Washington Wetland Rating System. Provide the wetland rating forms with the JARPA package.

³ Indicate the days, months or years the wetland will be measurably impacted by the activity. Enter "permanent" if applicable.

⁴ Creation (C), Re-establishment/Rehabilitation (R), Enhancement (E), Preservation (P), Mitigation Bank/In-lieu fee (B)

Page number(s) for similar information in the mitigation plan, if available: Pages 5 and 6

7i. For all filling activities identified in 7h, describe the source and nature of the fill material, the amount in cubic yards that will be used, and how and where it will be placed into the wetland. [\[help\]](#)

Because of their small sizes, the impacted wetlands will likely be filled during onsite grading activities and imported fill will not be needed. The onsite soils are composed of silty clay to clay loam.

7j. For all excavating activities identified in 7h, describe the excavation method, type and amount of material in cubic yards you will remove, and where the material will be disposed. [\[help\]](#)

N/A

Part 8–Waterbodies (other than wetlands): Impacts and Mitigation

In Part 8, “waterbodies” refers to non-wetland waterbodies. (See Part 7 for information related to wetlands.) [\[help\]](#)

Check here if there are waterbodies on or adjacent to the project area. (If there are none, skip to Part 9.)

8a. Describe how the project is designed to avoid and minimize adverse impacts to the aquatic environment. [\[help\]](#)

Not applicable

An agricultural ditch runs along the south property line and physically separates the offsite wetland from the project proposed on this property. The project has avoided impacts to the ditch by establishing a wetland buffer that will protect both the wetland and the ditch.

8b. Will your project impact a waterbody or the area around a waterbody? [\[help\]](#)

Yes No

8c. Have you prepared a mitigation plan to compensate for the project's adverse impacts to non-wetland waterbodies? [\[help\]](#)

- If Yes, submit the plan with the JARPA package and answer 8d.
- If No, or Not applicable, explain below why a mitigation plan should not be required.

Yes No Don't know

8d. Summarize what the mitigation plan is meant to accomplish. Describe how a watershed approach was used to design the plan.

- If you already completed 7g you do not need to restate your answer here. [\[help\]](#)

8e. Summarize impact(s) to each waterbody in the table below. [\[help\]](#)

Activity (clear, dredge, fill, pile drive, etc.)	Waterbody name ¹	Impact location ²	Duration of impact ³	Amount of material (cubic yards) to be placed in or removed from waterbody	Area (sq. ft. or linear ft.) of waterbody directly affected

¹ If no official name for the waterbody exists, create a unique name (such as "Stream 1") The name should be consistent with other documents provided.

² Indicate whether the impact will occur in or adjacent to the waterbody. If adjacent, provide the distance between the impact and the waterbody and indicate whether the impact will occur within the 100-year flood plain.

³ Indicate the days, months or years the waterbody will be measurably impacted by the work. Enter "permanent" if applicable.

8f. For all activities identified in 8e, describe the source and nature of the fill material, amount (in cubic yards) you will use, and how and where it will be placed into the waterbody. [\[help\]](#)

8g. For all excavating or dredging activities identified in 8e, describe the method for excavating or dredging, type and amount of material you will remove, and where the material will be disposed. [\[help\]](#)

Part 9–Additional Information

Any additional information you can provide helps the reviewer(s) understand your project. Complete as much of this section as you can. It is ok if you cannot answer a question.

9a. If you have already worked with any government agencies on this project, list them below. [\[help\]](#)

Agency Name	Contact Name	Phone	Most Recent Date of Contact
City of Chehalis	Deborah King	(360) 345-2229	June 2018
WA Dept. of Ecology	Zachary Meyer	(360) 407-7273	May 2019
U.S. Army Corps of Engineers	Evan Carnes	(206) 316-3049	May 2019

9b. Are any of the wetlands or waterbodies identified in Part 7 or Part 8 of this JARPA on the Washington Department of Ecology’s 303(d) List? [\[help\]](#)

- If **Yes**, list the parameter(s) below.
- If you don’t know, use Washington Department of Ecology’s Water Quality Assessment tools at: <http://www.ecy.wa.gov/programs/wq/303d/>.

Yes No

9c. What U.S. Geological Survey Hydrological Unit Code (HUC) is the project in? [\[help\]](#)

- Go to <http://cfpub.epa.gov/surf/locate/index.cfm> to help identify the HUC.

17100103

9d. What Water Resource Inventory Area Number (WRIA #) is the project in? [\[help\]](#)

- Go to <http://www.ecy.wa.gov/water/wria/index.html> to find the WRIA #.

WRIA 23

9e. Will the in-water construction work comply with the State of Washington water quality standards for turbidity? [\[help\]](#)

- Go to <http://www.ecy.wa.gov/programs/wq/swqs/criteria.html> for the standards.

Yes No Not applicable

9f. If the project is within the jurisdiction of the Shoreline Management Act, what is the local shoreline environment designation? [\[help\]](#)

- If you don't know, contact the local planning department.
- For more information, go to: http://www.ecy.wa.gov/programs/sea/sma/laws_rules/173-26/211_designations.html.

Urban Natural Aquatic Conservancy Other: _____

9g. What is the Washington Department of Natural Resources Water Type? [\[help\]](#)

- Go to <http://www.dnr.wa.gov/forest-practices-water-typing> for the Forest Practices Water Typing System.

Shoreline Fish Non-Fish Perennial Non-Fish Seasonal

9h. Will this project be designed to meet the Washington Department of Ecology's most current stormwater manual? [\[help\]](#)

- **If No**, provide the name of the manual your project is designed to meet.

Yes No

Name of manual: City of Chehalis Development Regulations

9i. Does the project site have known contaminated sediment? [\[help\]](#)

- **If Yes**, please describe below.

Yes No

9j. If you know what the property was used for in the past, describe below. [\[help\]](#)

Possibly used as pasture in the distant past. Most recently the property has been used as an extended yard/play area for the tenants in the existing house.

9k. Has a cultural resource (archaeological) survey been performed on the project area? [\[help\]](#)

- **If Yes**, attach it to your JARPA package.

Yes No

9l. Name each species listed under the federal Endangered Species Act that occurs in the vicinity of the project area or might be affected by the proposed work. [\[help\]](#)

Marbled murrelet (*Brachyramphus marmoratus*) - Threatened
Streaked horned lark (*Eremophila alpestris strigata*) - Threatened
Yellow-billed cuckoo (*Coccyzus americanus*) - Threatened
Bull trout (*Salvelinus confluentus*) - Threatened
North American wolverine (*Gulo gulo luscus*) – Proposed Threatened

The site and the onsite wetlands provide no habitat for species that are listed as endangered or threatened. There will be no effect to critical habitat or individuals caused by this project because of the small area of impact and the maintained field condition found onsite.

9m. Name each species or habitat on the Washington Department of Fish and Wildlife's Priority Habitats and Species List that might be affected by the proposed work. [\[help\]](#)

Freshwater forested, scrub/shrub, emergent wetland-offsite to the south
No priority habitats or species on the property.

Part 10–SEPA Compliance and Permits

Use the resources and checklist below to identify the permits you are applying for.

- Online Project Questionnaire at <http://apps.oria.wa.gov/opas/>.
- Governor's Office for Regulatory Innovation and Assistance at (800) 917-0043 or help@oria.wa.gov.
- For a list of addresses to send your JARPA to, click on [agency addresses for completed JARPA](#).

10a. Compliance with the State Environmental Policy Act (SEPA). (Check all that apply.) [\[help\]](#)

- For more information about SEPA, go to www.ecy.wa.gov/programs/sea/sepa/e-review.html.

A copy of the SEPA determination or letter of exemption is included with this application.

A SEPA determination is pending with City of Chehalis (lead agency). The expected decision date is undetermined.

I am applying for a Fish Habitat Enhancement Exemption. (Check the box below in 10b.) [\[help\]](#)

This project is exempt (choose type of exemption below).

Categorical Exemption. Under what section of the SEPA administrative code (WAC) is it exempt?

Other: _____

SEPA is pre-empted by federal law.

10b. Indicate the permits you are applying for. (Check all that apply.) [\[help\]](#)

LOCAL GOVERNMENT

Local Government Shoreline permits:

- Substantial Development Conditional Use Variance
 Shoreline Exemption Type (explain): _____

Other City/County permits:

- Floodplain Development Permit Critical Areas Ordinance

STATE GOVERNMENT

Washington Department of Fish and Wildlife:

- Hydraulic Project Approval (HPA) Fish Habitat Enhancement Exemption – [Attach Exemption Form](#)

You must submit a check for \$150 to Washington Department of Fish and Wildlife, unless your project qualifies for an exemption or alternative payment method below. **Do not send cash.**

Check the appropriate boxes

- \$150 check enclosed. Check # _____
Attach check made payable to Washington Department of Fish and Wildlife.
- My project is exempt from the application fee. (Check appropriate exemption):
- All parts of project (except compensatory mitigation) occur landward of Ordinary High Water Line (OWHL).
 - HPA processing is conducted by applicant funded WDFW staff.
Agreement # _____
 - Mineral prospecting and mining
 - Project occurs on farm and agricultural land.
(Attach a copy of current land use classification recorded with the county auditor, or other proof of current land use)
 - Project is modification of an existing HPA originally applied for, prior to July 10, 2012.
HPA # _____

Washington Department of Natural Resources:

- Aquatic Use Authorization
Complete [JARPA Attachment E](#) and submit a check for \$25 payable to the Washington Department of Natural Resources.
Do not send cash.

Washington Department of Ecology:

- Section 401 Water Quality Certification

FEDERAL GOVERNMENT

United States Department of the Army permits (U.S. Army Corps of Engineers):

- Section 404 (discharges into waters of the U.S.) Section 10 (work in navigable waters)

United States Coast Guard permits:

- General Bridge Act Permit Private Aids to Navigation (for non-bridge projects)

Part 11—Authorizing Signatures

Signatures are required before submitting the JARPA package. The JARPA package includes the JARPA form, project plans, photos, etc. [\[help\]](#)

11a. Applicant Signature (required) [\[help\]](#)

I certify that to the best of my knowledge and belief, the information provided in this application is true, complete, and accurate. I also certify that I have the authority to carry out the proposed activities, and I agree to start work only after I have received all necessary permits.

I hereby authorize the agent named in Part 3 of this application to act on my behalf in matters related to this application. _____ (initial)

By initialing here, I state that I have the authority to grant access to the property. I also give my consent to the permitting agencies entering the property where the project is located to inspect the project site or any work related to the project. _____ (initial)

Kevin Hubbard

Applicant Printed Name

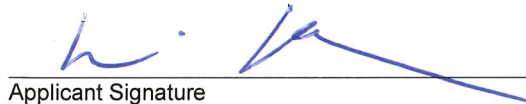

Applicant Signature

_____ Date

11b. Authorized Agent Signature [\[help\]](#)

I certify that to the best of my knowledge and belief, the information provided in this application is true, complete, and accurate. I also certify that I have the authority to carry out the proposed activities and I agree to start work only after all necessary permits have been issued.

Joanne Bartlett

Authorized Agent Printed Name



Authorized Agent Signature

June 11, 2019

_____ Date

11c. Property Owner Signature (if not applicant) [\[help\]](#)

Not required if project is on existing rights-of-way or easements (provide copy of easement with JARPA).

I consent to the permitting agencies entering the property where the project is located to inspect the project site or any work. These inspections shall occur at reasonable times and, if practical, with prior notice to the landowner.

_____ Property Owner Printed Name

_____ Property Owner Signature

_____ Date

18 U.S.C §1001 provides that: Whoever, in any manner within the jurisdiction of any department or agency of the United States knowingly falsifies, conceals, or covers up by any trick, scheme, or device a material fact or makes any false, fictitious, or fraudulent statements or representations or makes or uses any false writing or document knowing same to contain any false, fictitious, or fraudulent statement or entry, shall be fined not more than \$10,000 or imprisoned not more than 5 years or both.

If you require this document in another format, contact the Governor's Office for Regulatory Innovation and Assistance (ORIA) at (800) 917-0043. People with hearing loss can call 711 for Washington Relay Service. People with a speech disability can call (877) 833-6341. ORIA publication number: ORIA-16-011 rev. 03/2017

6/11/2019 2:04 PM 3040 Jackson Highway.dwg Jennifer



6/11/2019 2:04 PM 3040 Jackson Highway.dwg Jennifer

LEGEND:

- Site Boundary
- Wetland (Delineated 06-29-17)
- Wetland Buffer
- ← Agricultural Ditch w/ Flow Direction

Wetlands A-H & J-O	Wetland I
Category IV	Category II
Depressional	Depressional
Emergent	Scrub-shrub, Emergent
Seasonally Flooded	Seasonally Flooded
Wetland A 988 sq. ft.	Wetland I 382 sq. ft.
Wetland B 84 sq. ft.	Wetland J 51 sq. ft.
Wetland C 343 sq. ft.	Wetland K 30 sq. ft.
Wetland D 96 sq. ft.	Wetland L 46 sq. ft.
Wetland E 89 sq. ft.	Wetland M 133 sq. ft.
Wetland F 151 sq. ft.	Wetland N 83 sq. ft.
Wetland G 56 sq. ft.	Wetland O 50 sq. ft.
Wetland H 208 sq. ft.	



<p>PURPOSE: Mitigation Plan</p> <p>DATE: NAD83</p> <p>ADJACENT PROPERTY OWNERS:</p>	<p>SITE PLAN</p> <p>APPLICANT: H.E. & Sons Construction, LLC</p> <p>PROJECT NAME: 3040 Jackson Highway</p> <p>REFERENCE #:</p> <p>SITE LOCATION ADDRESS: 3040 Jackson Highway, Chehalis, WA</p>	<p>PROPOSED: Jackson Highway Corridor</p> <p>NEAR: Maintained Field</p> <p>CHEHALIS:</p> <p>COUNTY: Lewis</p> <p>STATE: WA</p> <p>SHEET 3 OF 5</p> <p>DATE: 6/11/19</p>
	<p>SCALE IN FEET</p> <p>0 50 100</p> <p>1157 3rd Ave., Suite 220A Longview, WA 98632 Phone: (360) 578-1371</p> <p>Ecological Land Services</p>	

6/11/2019 2:04 PM 3040 Jackson Highway.dwg Jennifer

LEGEND:

- Site Boundary
- Wetland (Delineated 06-29-17)
- Wetland Buffer
- ← Agricultural Ditch w/ Flow Direction
- Direct Wetland Impact (133 sq. ft.)
- Wetland Buffer Impact (21,277 sq. ft.)
- Wetland Enhancement Area (2,032 sq. ft.)
- Buffer Enhancement Area (26,770 sq. ft.)

- | | |
|-------------------------------|-----------------------|
| Wetlands A-H & J-O | Wetland I |
| Category IV | Category II |
| Depressional | Depressional |
| Emergent | Scrub-shrub, Emergent |
| Seasonally Flooded | Seasonally Flooded |
-
- | | |
|-----------------------|-----------------------|
| Wetland A 988 sq. ft. | Wetland I 382 sq. ft. |
| Wetland B 84 sq. ft. | Wetland J 51 sq. ft. |
| Wetland C 343 sq. ft. | Wetland K 30 sq. ft. |
| Wetland D 96 sq. ft. | Wetland L 48 sq. ft. |
| Wetland E 89 sq. ft. | Wetland M 133 sq. ft. |
| Wetland F 151 sq. ft. | Wetland N 83 sq. ft. |
| Wetland G 56 sq. ft. | Wetland O 50 sq. ft. |
| Wetland H 208 sq. ft. | |

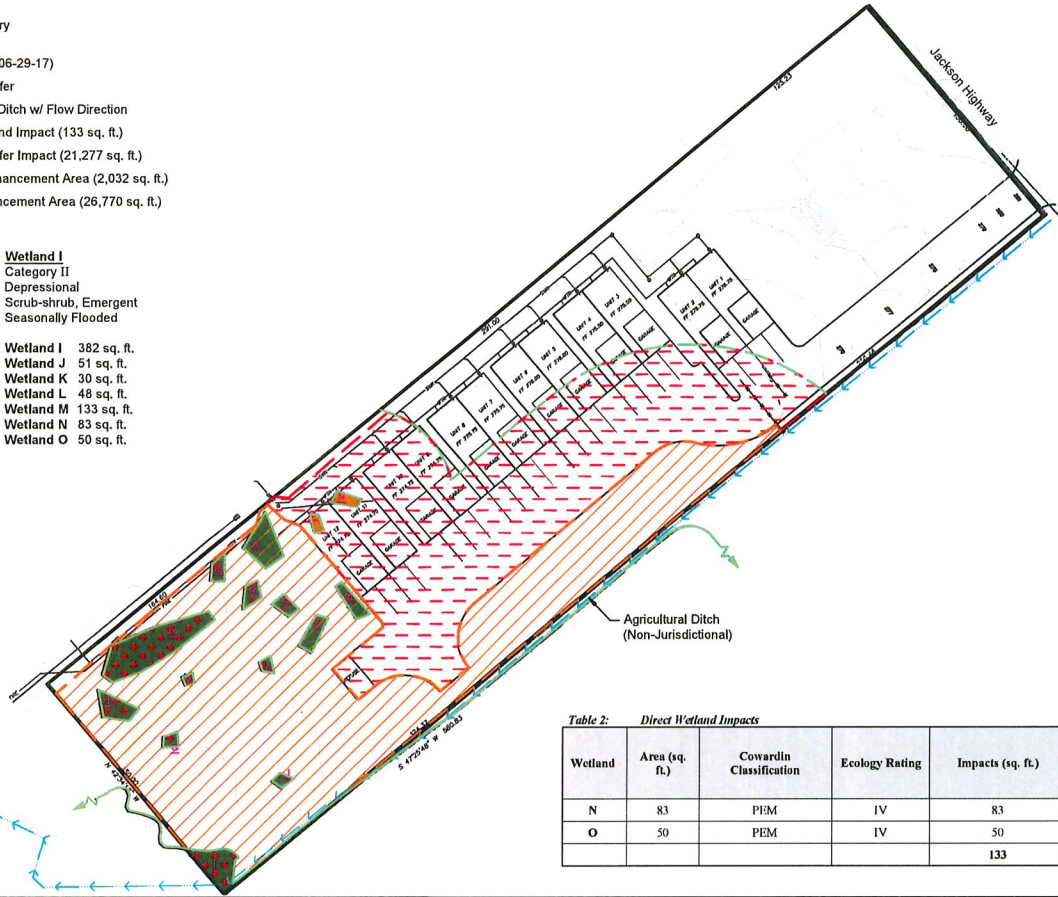

Table 2: Direct Wetland Impacts

Wetland	Area (sq. ft.)	Cowardin Classification	Ecology Rating	Impacts (sq. ft.)
N	83	PEM	IV	83
O	50	PEM	IV	50
				133



SCALE IN FEET
0 50 100

PURPOSE: Mitigation Plan

MITIGATION PLAN OVERVIEW
APPLICANT: Hubbard & Sons Construction, LLC
PROJECT NAME: 3040 Jackson Highway
DATUM: NAD83
ADJACENT PROPERTY OWNERS: 3040 Jackson Highway, Chehalis, WA

PROPOSED: Jackson Highway Corridor
 IN Maintained Field
 NAK, Chehalis
 COUNTY: Lewis
SHEET 4 OF 5
STATE: WA
DATE: 6/11/19

ECOLOGICAL Land Services
 1157 3rd Ave., Suite 210A
 Longview, WA 98632
 Phone: (360) 578-1371

6/11/2019 2:04 PM 3040 Jackson Highway.dwg Jennifer

